

# CAMBRIDGE

## CA 750 MINIATURE HOUSE KIT ASSEMBLY INSTRUCTIONS



FINISHED SIZE: 43"H X 33"W X 22"D

SCALE: 1" = 1'

*Dura-Craft, Inc.*

P.O. Box 438 • Newberg, Oregon 97132

phone: (503) 538-3136

REV  
6-22-92

# CAMBRIDGE

## CA 750 MINIATURE HOUSE KIT

### ASSEMBLY INSTRUCTIONS

Congratulations on selecting a miniature house kit manufactured by Dura-Craft, Inc., the leader in the industry. We pride ourselves in our high quality and workmanship. Each piece is graded and sorted at several different stages to ensure that you receive the finest quality.

A Dura-Craft miniature house is a complete kit. You will not have to make

separate purchases of items like the windows and shingles which are a basic part of your house. Your finished house will be ready for painting, wallpapering and decorating.

Your finished house will be of heirloom quality, of which you will be justly proud, if ample time and care are used in its construction and finishing.

## ASSEMBLY INSTRUCTIONS

Here are several construction tips that will help you avoid some problems when you build your miniature house.

An important thing to keep in mind about the kit parts: They are made of wood. Wood shrinks and expands according to humidity. We have found that the siding is most sensitive to dimension changes due to humidity. All siding used in Dura-Craft miniature houses is made from the finest kiln dried Ponderosa Pine. However, as a result of humidity and assembly with a water base glue, some swelling will occur, causing slight dimension changes. Wall panels should be left in a warm dry room at least 48 hours before corner posts are attached. This

will prevent walls from cracking. At no time should the house be placed in a cold damp area.

If there is a minor cracking problem there is a simple solution. A thick bead of glue should be run into the gap. Wipe off any excess glue and allow to dry. If necessary, repeat this step until the gap is filled. When the house is painted, there will be no evidence of the gap. We recommend a good quality OIL base paint be applied on any siding to be painted.

**WALL PANELS DO NOT COME ASSEMBLED IN THE KIT. FOLLOW INSTRUCTIONS TO ASSEMBLE WALL PANELS.**

**NOTE:** For shortages or broken parts write directly to Dura-Craft, Inc. for replacement, using the form on the last page of this manual.

## READ THIS BEFORE STARTING ASSEMBLY

The following tips will help you avoid problems when you build your miniature house.

1. **Save the box.** The photo will be very helpful during assembly.

2. Do not remove any pieces from their punch sheet before they are called for in the instructions. This will reduce part warpage and make part identification easier. But, if you plan to paint your house it is easiest to paint all parts before assembly. The walls are best painted after they have been glued together.

3. Read through the instructions carefully once to get a feel for the assembly process and to gain familiarity with the parts.

4. Follow the instructions in order.

5. **If you cannot release a part from its board with moderate pressure, then carefully cut it loose with a utility knife. Always cut from the good side of the board where the cut lines are clearly visible.**

6. If any parts are missing or damaged, they can be quickly replaced by Dura-Craft. Please write or call and give us the name and sheet number of the part or parts that you need. We have included a "Missing and Broken Parts Replacement Form" to assist you. It may save time to make missing or broken parts from the scrap material.

7. We recommend the use of Aleene's Tacky Glue to construct your house. This glue helps hold parts in place while it dries, and it dries clear. It can be found at most craft supply stores. Any white household glue or woodworking glue may be substituted if desired. Wipe away excess glue while it is still fresh.

8. Dura-Craft has done everything possible to ensure that your kit will look good when it is complete. We have included pine moldings to strengthen the house and trim to cover all of the outside wall and floor edges, and we have designed the kit so that slot and tab positions will be hidden when the kit is finished. However, the final quality of your house will depend to some extent on the care you take in preparing each piece for assembly. Sanding is optional, but it will improve your house. It will also remove splinters from the edges of the parts which will help the parts fit better.

9. You will need the following materials to assist you in the assembly of your miniature house:

- Glue (see paragraph 7 above)
- Utility knife or sharp, sturdy knife
- 3/4" masking tape
- Damp cloth
- Ruler or tape measure
- Fine toothed saw such as a coping or hacksaw is helpful
- Pencil
- 100 grade (med.) sand paper
- A roll of waxed paper
- Several large books to use as weights
- A framing square
- Contact cement (for hardwood floor)
- Steel wool (for hardwood floor)
- Small "C" clamps come in handy

## GLOSSARY

- Good side- The side the pieces were stamped from. The smoothest side.
- Bead of glue- A line of glue about as large as a pencil lead.
- " - inches.
- Flush- When the edges of two boards are even.
- Left and right sides- All references will be made from the front view, unless otherwise instructed.
- Tab- A projection off the edge of a board.
- Slot- A hole in a board that a tab fits into.
- Notch- The same as a slot, except it's on the edge of a board.
- Glass- Silkscreened plastic sheets

**INVENTORY LIST**

**Part No. CA-1 through CA-30**  
30 stamped sheets of parts  
(See back of instructions)

Siding:

Part No.	Length	Quantity
1-9	1 1/4"	6
1-29	1 3/8"	6
1-38	1 7/8"	16
1-11	2"	19
1-8	2 1/2"	6
1-5	2 3/4"	3
1-4	3"	32
1-39	6 1/4"	9
1-40	6 7/8"	2
1-18	9"	4
1-17	11"	17
1-44	11 7/8"	13
1-45	16 3/16"	1
1-16	18 1/2"	2

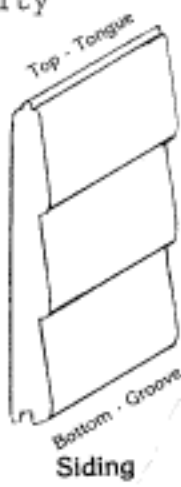

Siding

**Part No. 5-142**  
6 1/2' of gutter

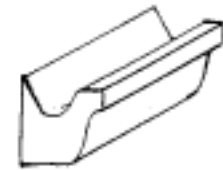

Gutter

**Part No. 5-143**  
2 1/2' of downspout



Downspout

**Part No. 5-147**  
5 1/2' of 1/4"x1/2"  
molding

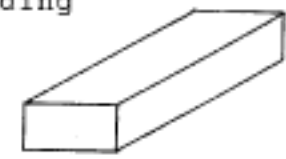

1/4"x1/2" Molding

**Part No. 5-141**  
39 brackets

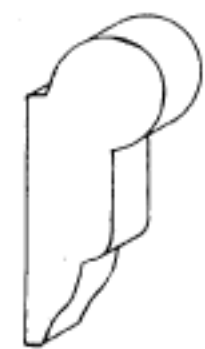

Bracket

**Part No. 6-19**  
121' of hardwood flooring



Hardwood Flooring

**Part No. 6-33**  
1 silkscreened sheet of windows

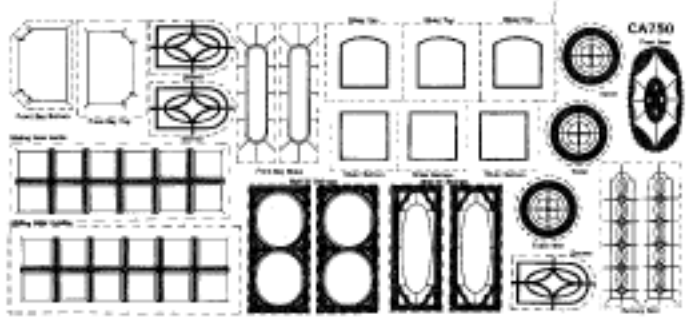

**Part No. 5-150**  
550 plain shakes (1 1/8")

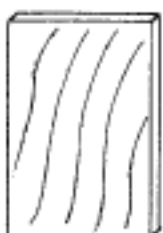

Plain Shake

**Part No. 5-151**  
650 fancy shakes



Fancy Shake

Part No. 5-2 Stock  
14' of large corner post

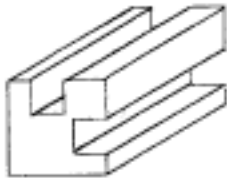

Large Corner Post

Part No. 5-70  
30' of small edge trim

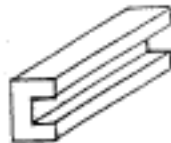

Small Edge Trim

Part No. 7-1  
13' of brick template  
tape

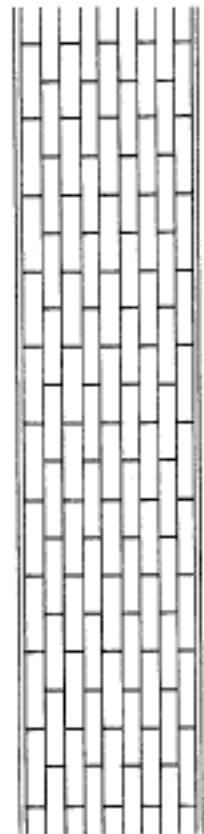

Part No. S5-2 Stock  
2' of small corner post

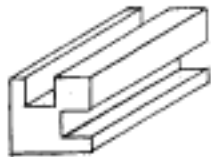

Small Corner Post

Part No. 5-37  
2 pc. 1/2"x1/2"x9 3/4" molding

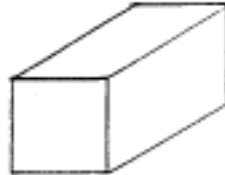

1/2" x 1/2" Molding

Part No. 5-76 Stock  
9' of large tower corner post

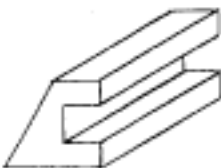

Large Tower Corner Post

Part No. 5-46  
17' of 1/4"x1/4" molding

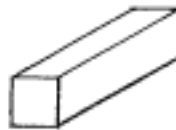

1/4" x 1/4" Molding

Part No. S5-76 Stock  
18' of small tower corner post

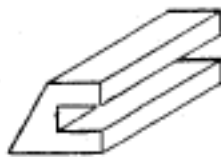

Small Tower Corner Post

Part No. 5-3  
52' of universal trim

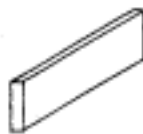

Universal Trim

Part No. 7-2  
13 oz. brick powder



Part No. 5-41 Stock  
5' of medium edge trim

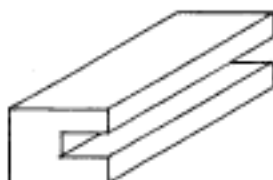

Medium Edge Trim

Part No. 5-19  
1 1/2' of redwood trim



Redwood Trim

Part No. 6-17  
4 pc. door knobs

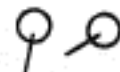

**WALL PANELS**

1. Locate all siding pieces.
  2. Pre-assemble the siding without glue. Lay the pieces flat side down, as shown in Figure 1. The tongue is on the top edge of each board.
  3. Use a framing square to insure that the ends of the siding pieces are properly aligned. Make light pencil marks at the top and bottom of each window and door opening for final assembly.
  4. Prepare an area for gluing. You will need a hard, flat surface at least three feet by four feet in size. Select a location where the wall panels will not have to be disturbed for several hours after gluing. Tape waxed paper over the entire surface.
  5. Use the following technique for gluing the wall panels: Apply a thin bead of glue to the tongue then seat it in the groove. Immediately wipe off any surplus glue that squeezes out, using a damp- but not wet- cloth. Assemble the panels flat side down on the waxed paper. Make sure that all parts are arranged in the correct sequence relative to the pencil marks made in Step #3 above for the door and window openings.
  6. Make sure that all joints are tight, and that edges of the walls are square and flush. Place weights on the panels as you finish them. Allow about an hour for the glue to set before moving or adding to the panels. The house is designed to the outside wall edge measurements, door and window opening measurements may vary.
- IMPORTANT:** If you must leave the wall panels incomplete for more than two or three hours during this phase of the construction, stand them on edge to allow air to circulate around both sides. This will minimize the likelihood of warping.
7. When wall panels are complete and have set for about an hour, stand them on edge to allow air to reach both sides. Let wall panels dry in a warm, dry place for at least 24 hours, preferably 48 hours.
  8. After the 48 hours, we recommend sealing the siding with a sanding sealer or other non-water based sealer. This will keep moisture out of the wood and prevent cracking. Seal the inside and the outside of the siding.

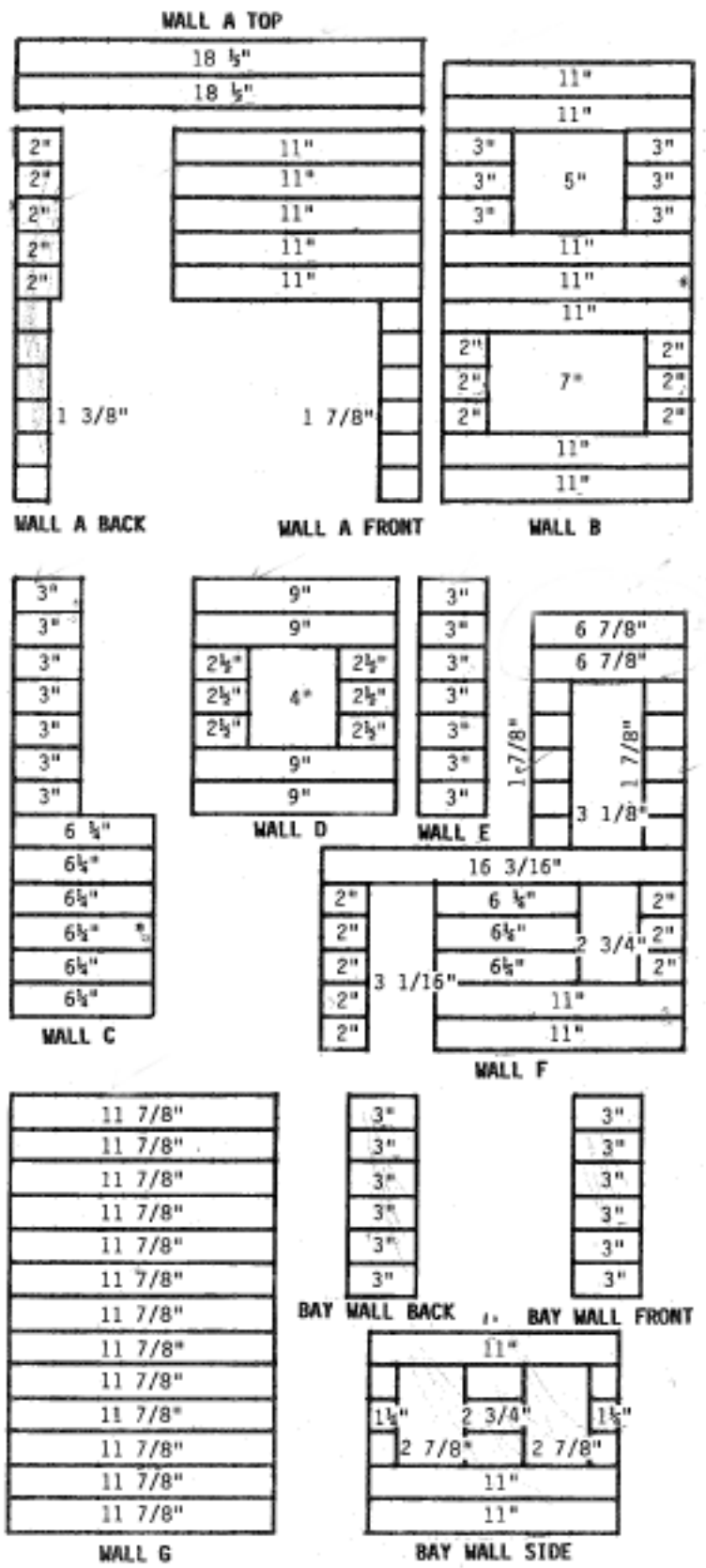

Figure 1

## FLOOR SUPPORT MARKS

1. Lay the walls flat side up. Measure and make marks 9 1/2" up from the bottom of each wall. Continue up the taller walls and make marks 9 7/8" above the first marks.

2. Later, you will glue 1/2"x1/2" molding (5-46) to the walls making the bottom of the 5-46 even with the marks. Figure 2.

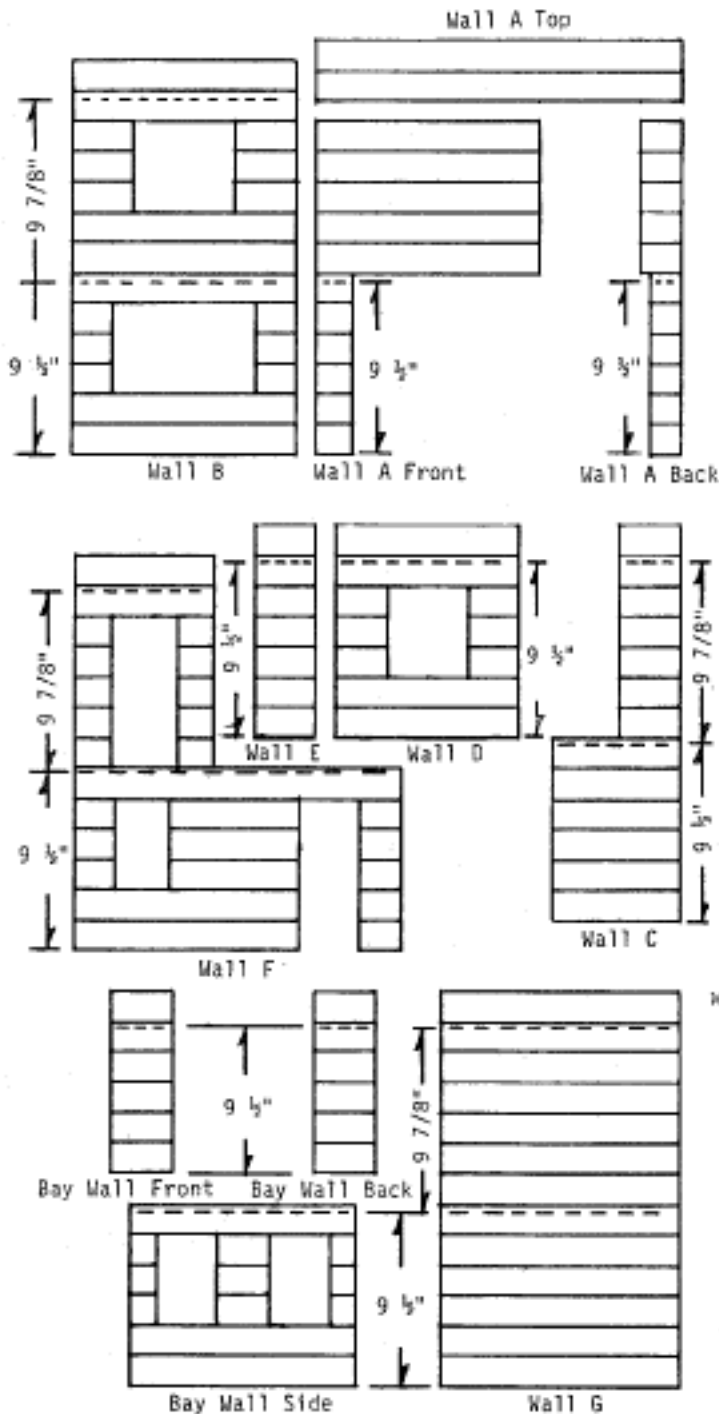
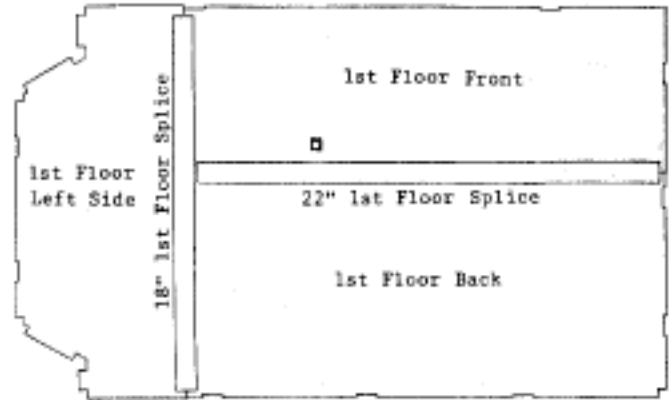

Figure 2

## BASE

1. Locate base floor back, base floor front, left base floor, and base floor splices (Sheets CA-1,2,3). With the good sides of the floor parts facing down splice base floor together by gluing and taping the splices in place as in Figure 3.



Good sides down Figure 3

2. Locate 2 of the Base Floor Supports (Sheet CA-2).

3. Locate the Base Walls 1, 2, 4, and 5 (Sheet CA-4). Glue and interlock the notches. Glue one of the base floor supports to the bad side of each splice. Figure 4.

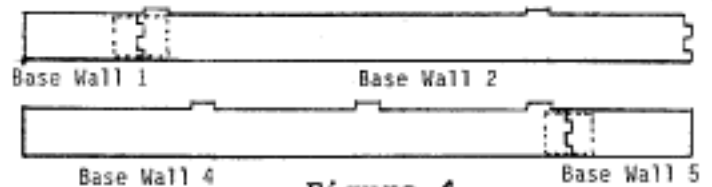

Figure 4

4. Locate the Base Walls 3, 6, 7, 8, 9, and 10, and the remaining Base Floor Supports (Sheets CA-2,3,4).

5. Glue base walls and base floor supports to the base floor assembly as in Figure 5.

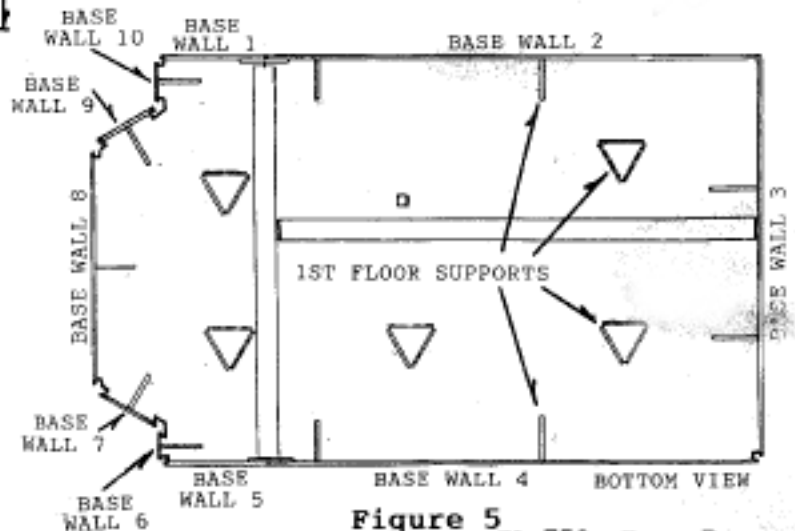

Figure 5

## HARDWOOD FLOORING

The hardwood flooring kit contains enough hardwood strips to cover **only** one floor of the house. This material may alternatively be applied to the door, stairways, or be used as wall paneling, but not all. **Do not use water base glue for flooring as it will cause the hardwood strips to curl.**

1. The edges of the hardwood strips may need to be **lightly** sanded to remove burrs.

2. Brush contact cement on the base floor and on one side of the hardwood strips. Follow the instructions on the contact cement.

**WARNING:** Contact cement is extremely volatile and flammable. The working area must be well ventilated. Keep away from flame or sparks.

3. Start laying the hardwood strips at the back of the house and work toward the front. Cut the strips with scissors. Off-set the joints as shown in Figure 6.

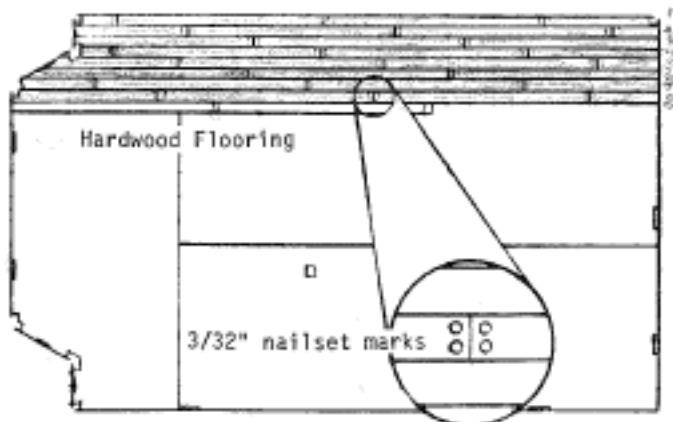

Figure 6

4. After the hardwood strips are in place, burnish them down by rubbing them firmly with a small wood block.

5. To achieve a pegged appearance, punch the ends of each strip with a 3/32" nail set as in Figure 6.

6. Sand the flooring smooth and remove any traces of contact cement that would interfere with the positioning of the walls on the base.

7. Using a sharp knife, carefully cut the flooring away from covering the square hole in the floor. This is best done from the underside of the floor.

8. Varnish the hardwood flooring with two or three coats of satin sheen polyurethane varnish. Steel wool lightly between coats.

## CHIMNEY

1. Locate the Chimney parts (Sheet CA-23).

2. Assemble as in Figure 7.

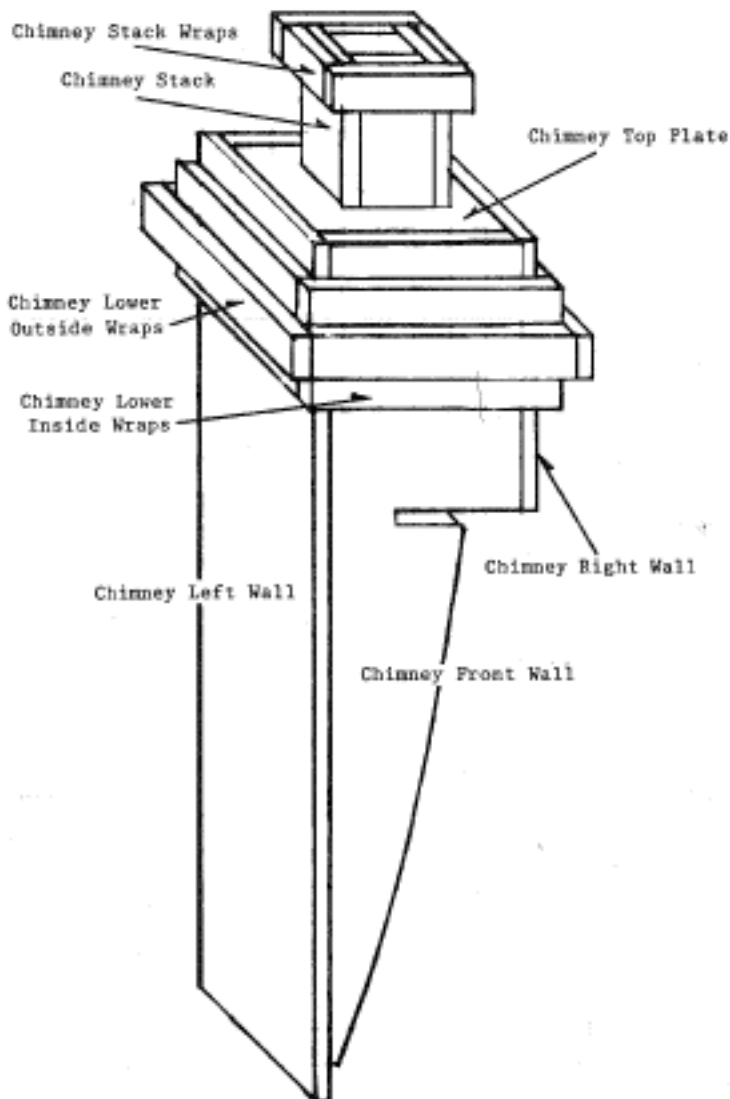

Figure 7

## BRICKWORK

2. Paint the base walls and chimney. This paint will become the mortar lines between the bricks. Black, white, and grey are popular. Let dry.

3. Peel enough webbing from the brick template tape to cover the area to be bricked. Leave about 2" hanging off one end. Press firmly for full contact.

4. Stick a scrap piece of wood about 4" long to the overhanging webbing.



5. To cover 1 foot of brick template tape it takes 1 ounce or 1½ tablespoons of brick powder. Premix white Tacky glue and water to the ratio of 2 parts glue to 1 part water (3 tablespoons of glue and 1½ tablespoons of water should be enough to start with). Mix well. Put about ½ cup of brick powder into a cup. **Slowly add small amounts** of glue mixture to the brick powder (It is easy to add too much glue mixture). Mix after each addition. Continue until mixture starts to hold its own shape.

6. Spread brick mix over webbing with a putty knife until it is about 1/16" thick. If you would like to paint the brick to change its color or give it an aged look, then spray it now before the webbing is removed.

7. Remove the webbing while the brick is still soft. Roll the stick under and raise it up so the webbing is at about a 45 degree angle to the surface. Keep rolling the webbing onto the stick. If needed, touch up the bricks while they are still soft. Figure 8.

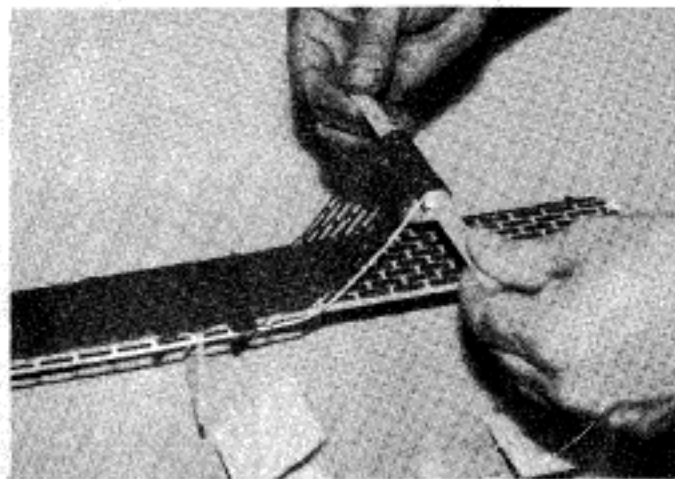

Figure 8

8. Use the same process for the chimney.

#### POSTS

1. Cut eight 11 7/8" lengths of Large Tower Corner Post (Part No. 5-76). Lay a strip of masking tape on the table with the sticky side up. Lay the posts on the tape with the ends flush as in Figure 9.

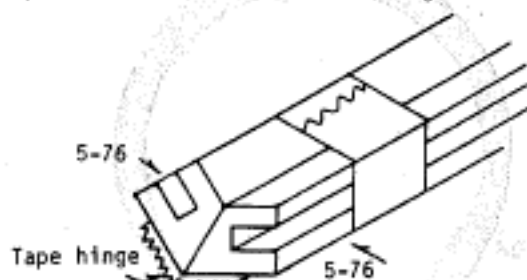

Figure 9

2. Run a Bead of glue in the "V" of the posts and tape together using the tape as a hinge. Repeat this process until you have 4 of these assemblies.

#### PAINT AND WALLPAPER

1. A better paint job is attained when all of the parts are painted prior to assembly as opposed to painting the house after it is assembled, but this runs the risk of losing parts or not being able to identify the loose parts. Also these instructions refer to the good side of the stamped parts. This is the smoothest side, the side the boards were punched from. For non-directional parts, it makes less difference, but for directional parts it makes all the difference. Therefore our recommendation is to gather all of the parts for each assembly, such as all front door parts, and put them in a bag. Keep these parts together until installed on the house. When the good side is called for, refer to the board diagrams at the back of the instructions for direction.

2. Lightly sand the punched edges of all parts to remove burrs.

3. Seal all parts with a non-water based wood sealer.

4. Paint all parts desired colors. Many parts only need one side and the edges painted since they will be glued to another surface.

5. Add wallpaper to appropriate wall panels. Refer to Figure 5 for back view wall layout. It will help conceal seams in wall paper if you paint the wall the same color as the background of the wallpaper where the seams will occur.

#### GLUE WALLS TOGETHER

1. From the large corner post (Part No. 5-2) cut:

- 3 - 23 5/8" lengths
- 2 - 21 1/2" lengths
- 1 - 11 7/8" length
- 3 - 11 5/8" lengths

The Walls, Mansards, Roof Trim, and Bracket Plates all have corresponding placement identification letters.

2. Dry fit walls together before gluing for correct corner post (5-2) orientation. To assemble the walls, run a bead of glue on the edges of the walls, then fit the walls into the grooves. Run a bead of glue along the underside of the walls. Wipe away excess glue with a damp cloth. **Fully seat walls into grooves.** Make sure there is no paint in the grooves of the posts. It may help to lightly sand the edges of the walls to remove burrs and excess paint.

3. The 11 7/8" length of Corner post (5-2) protrudes through the hole in the floor. Glue this post so it is flush with the top of the porch walls. Figure 10.

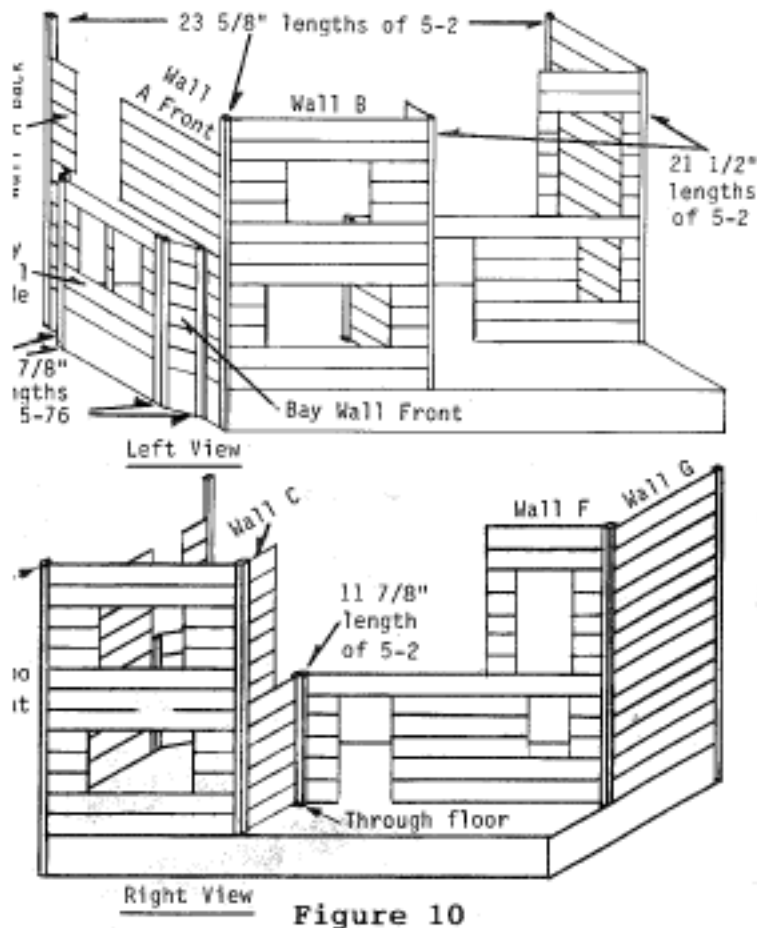
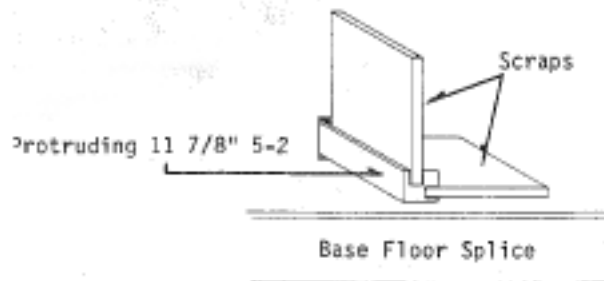

Figure 10

4. Glue the remaining 2 floor supports into the grooves of the corner post under the floor. Figure 11.



View from under the base.

Figure 11

## 2ND FLOOR

1. Glue 1/4"x1/2" molding (5-46) to the walls with the bottom edge of the 5-46 at the 9 1/2" wall marks to support the second floor only.

2. Locate the 2nd floor back, 2nd floor front, 2nd floor left side, and 2nd floor splices (CA-5,6,7).

3. Lay the floors good side down on the table. Glue the splices as in Figure 12.

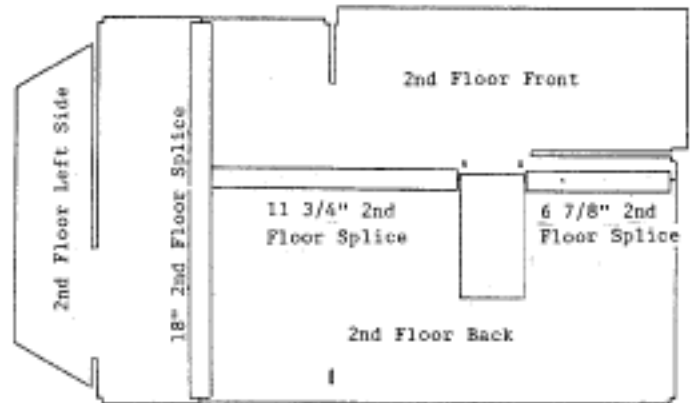

Figure 12

4. From the medium edge trim (Part No. 5-41) cut a 27 1/8" length.

5. Run a bead of glue along the top of the 2nd floor supports.

6. Slide the 2nd floor down the walls with the good side up until it rests on the supports.

7. Glue the 27 1/8" length of 5-41 to the back edge of the 2nd floor. Wrap a piece of tape around the corner of the wall and onto the 5-41 on each end to hold the walls from spreading. Place weights on the second floor around the edges.

## ASSEMBLE REMAINING WALLS

1. Assemble walls A Top, D and E as in Figure 13.

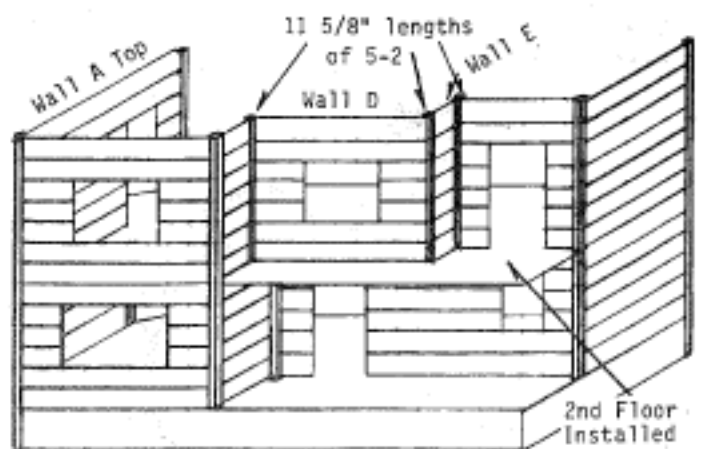

Figure 13

### 3RD FLOOR

1. Locate 3rd floor front, 3rd floor back, 3rd floor left side, and 3rd floor splices (Sheets CA-6,8,9,10).
2. With the good side down, splice floor parts together as in Figure 14.

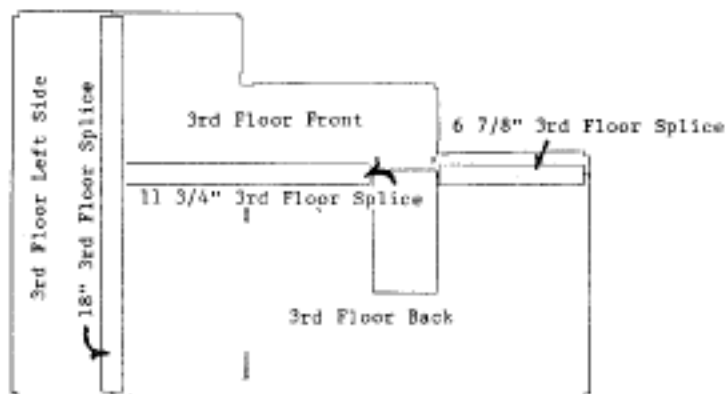

Figure 14

3. Glue the 1/4"x1/4" (part No. 5-46) pieces to the previously made marks on the walls to support the 3rd floor. Let Dry.
4. Cut a 27 1/8" length from the medium edge trim (Part No. 5-41).
5. Install 3rd floor. Glue and tape 5-41 to back edge of 3rd floor. Place weights on 3rd floor and let dry.

### DOUBLE HUNG WINDOWS (DHW)

1. Locate inside and outside double hung window surrounds, frames, decorative emblems and keystones, sills, and sliders (Sheets CA-7,9,10,30).
2. Cut out glass- "Slider Tops" and "Slider Bottoms".
3. Lay an outside surround/frame (the outside frame remains connected to the outside surround) on a table with the good side down. Run a thin bead of glue around the outside frame window opening. Spread glue evenly. With clean hands, place glass on the frame, make sure it is centered. With a pencil, press the glass down for full contact with the glue. Figure 15.

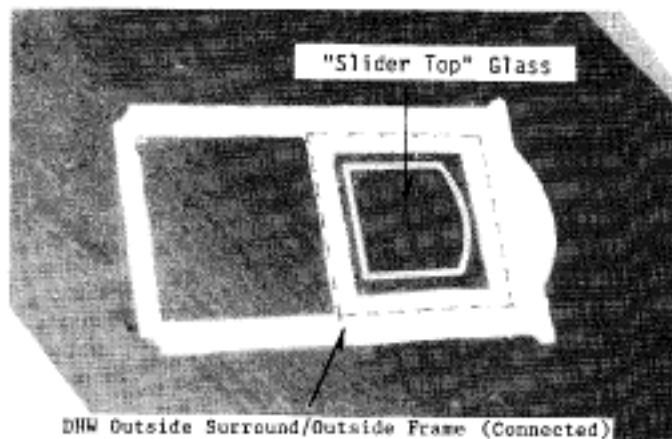

Figure 15

4. Assemble Double Hung Window assembly as in Figure 16. Lay the inside frame on the table with the good side down. Run a thin bead of glue around the opening. Spread glue evenly. Place the glass on the glue. Press glass down with a pencil. Run another bead of glue on the glass and spread evenly, be careful not to get glue on the part of the glass that will be seen. Place the slider on the inside frame on the inside frame with the good side up. Be sure it is centered. There should be 1/8" of slider overhanging each side of the inside frame. Figure 16.

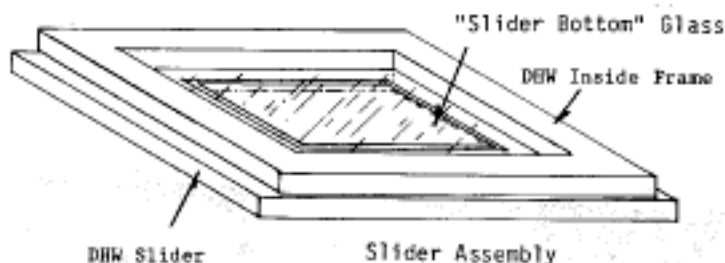

Figure 16

5. Dry fit double hung windows into the walls to be sure of proper operation. See Figure 17. To do this, tape the outside window surround centered on the outside of the window opening in the wall. From the inside, insert the slider assembly into the wall opening with the inside frame to the inside. Tape the inside window surround centered on the inside of the window opening in the wall. Raise the slider up and insert the sill diagonally and slide down. This process will tell you if you need to sand excess paint or burrs from the slider or surrounds for proper operation. Figure 17.

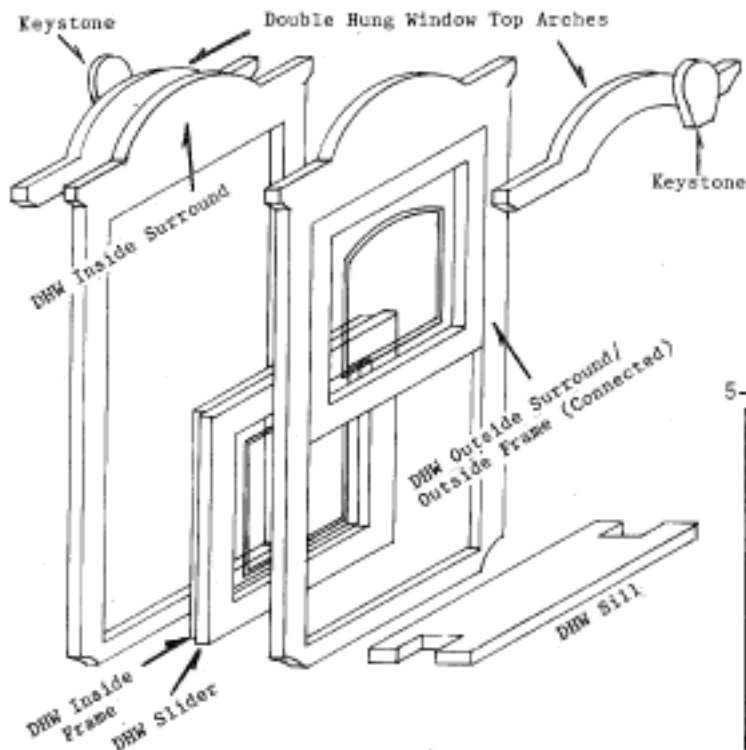

Figure 17

6. Glue in place. This may be done now or you can disassemble the window and glue one piece at a time. Make sure you don't get glue on any surfaces that the slider will come in contact with.

**FRONT BAY WINDOW**

1. Locate the front bay window parts (Sheet CA-29).
2. Cut out glass- "Front Bay Bottom", "Front Bay Top", and "Front Bay Sides".
3. Locate Inside Frame and Slider. Assemble as with the Double Hung Window.
4. From the Large Tower Corner Post (5-76) cut:  
2 - 4 3/4" lengths  
From the Small Tower Corner Post (S5-76) cut:  
6 - 4 3/4" lengths
5. Glue 4 of the Small Tower Corner Posts (S5-76) together to form 2 assemblies just as with the left bay wall posts. See Figure 9.
6. Glue 1 Large Tower Corner Post (5-76) to 1 Small Tower Corner Post (S5-76) as in Figure 18. Repeat with remaining two posts.

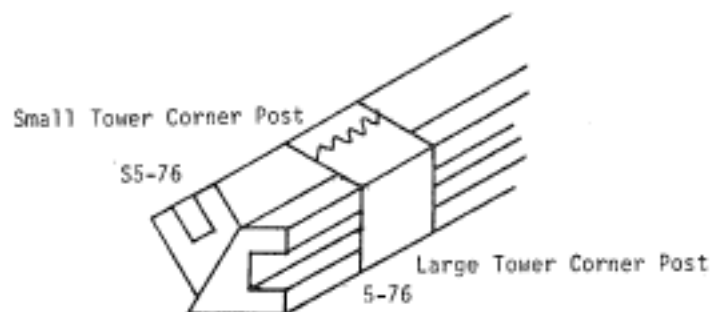

Figure 18

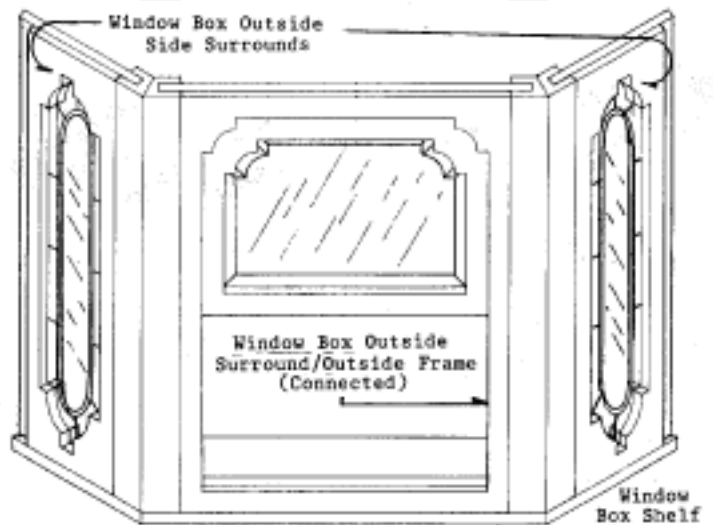
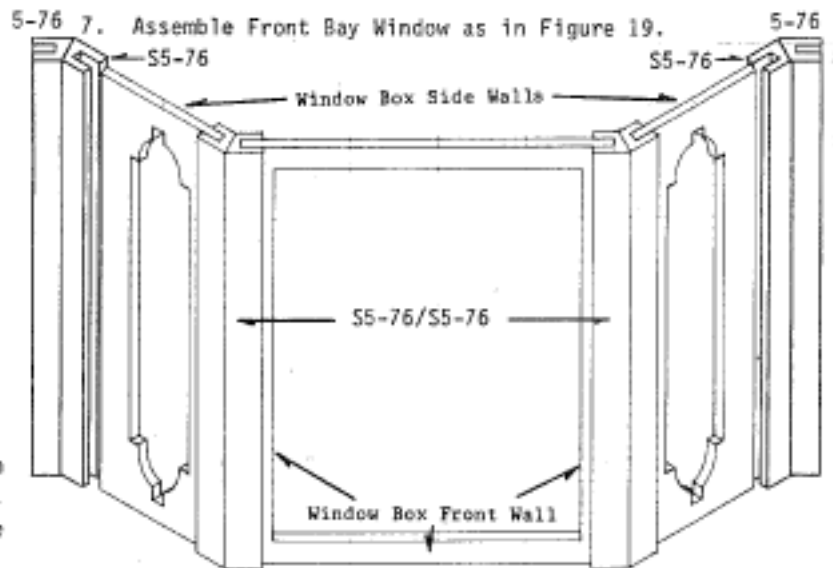

Figure 19

8. Lay the Roof and Bottom good side down exactly as they are positioned in the sheet. Tape the parts together. Glue in place as in the front view.

**SLIDING DOOR**

1. Locate the Sliding Door Parts (Sheets CA-25,26).
2. Cut out "Sliding Door Inside" and "Sliding Door Outside" glass.

3. Assemble same as double hung windows, except the slider moves side to side. Figure 20.

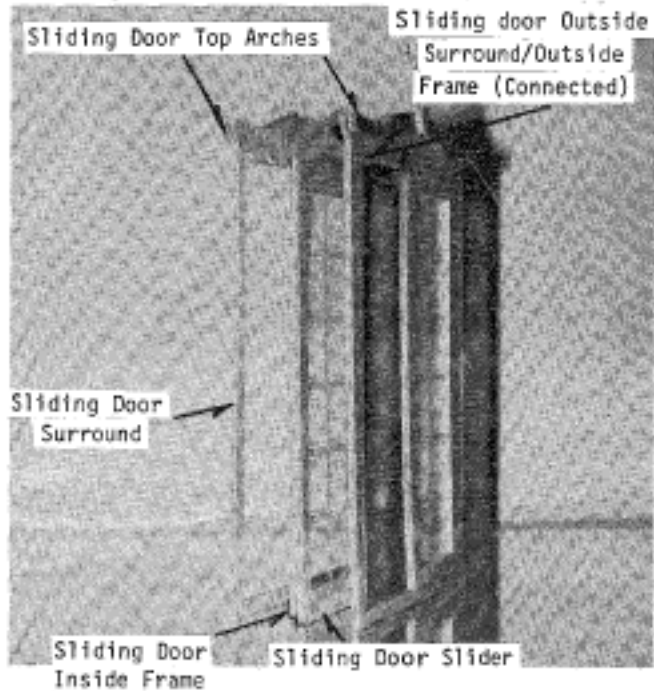

Figure 20

#### FRONT DOOR

1. Locate front door inside and outside panels, inside and outside surround, decorative emblems, decorative inserts, and top and bottom pivot plates keystones (Sheets CA-20,25).

2. Cut out "Front Door" window.

3. Lay the outside front door panel on the table with the good side down. Glue the Inside Panel to the Outside Panel. Make sure the pivot pins on the panels line up on the same side. See Figure 21.

4. Glue the glass centered on the inside of the Inside Panel. Glue the Inside Front Door Window Surround to the Inside Door Panel.

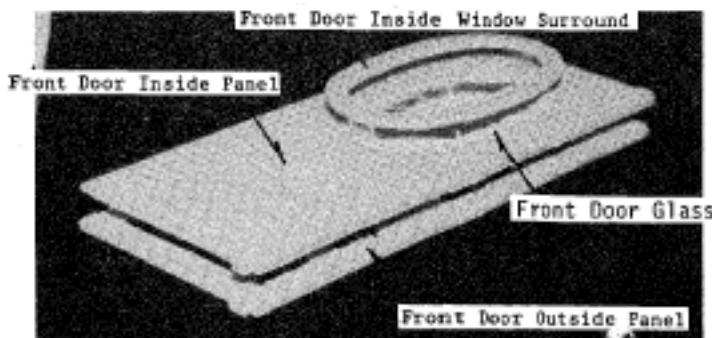

Figure 21

5. Glue the decorative inserts to the inside door panels. See front view.

6. Sand or carve the pivot pins round so they will snugly fit into the holes in the pivot plates. Figure 22.

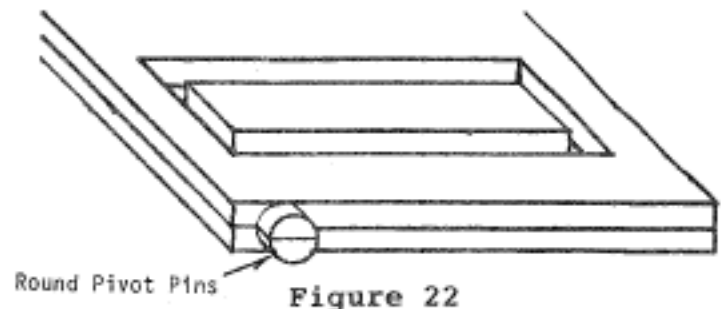

Figure 22

7. Dry assemble the door parts into the front door wall opening. To do this, tape the inside and outside front door surrounds centered on the front door wall opening. Fit the front door pivot pins into the top and bottom pivot plates. Slide doors and pivot plates into the doorway. If doors operate smoothly, then glue assembly together. Figure 23.

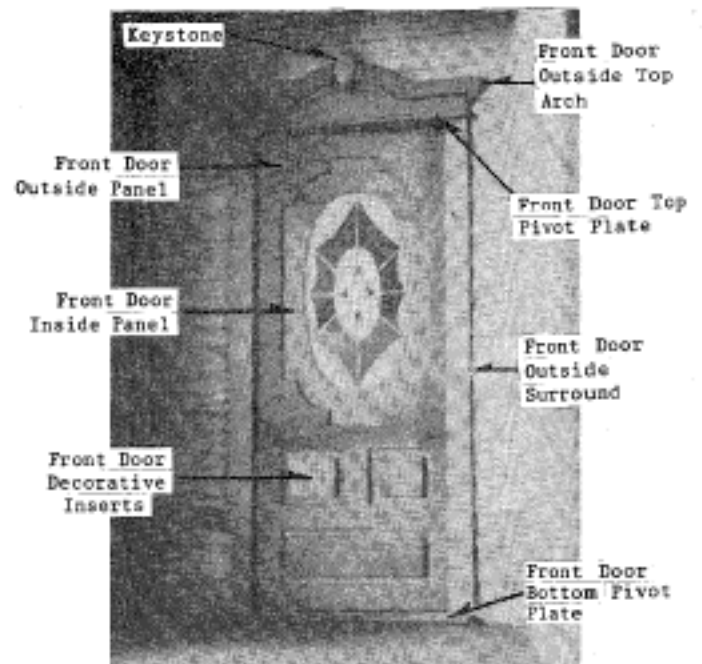

Figure 23

### WALL "B" SWINGING WINDOWS

1. Locate Wall "B" Window parts (Sheets CA-17,21, 30).
2. Cut out "Wall 'B' Swinger" window glass.
3. Sandwich and glue glass between the inside and outside frames. Make sure pivot pins line up.
4. Round pivot pins so they fit into pivot plate holes.
5. Assemble Wall B Window parts as in Figure 24. Insert frames into top and bottom pivot plates, then insert assembly into the outside surround. Add roof supports, outside top arch, and window roofs. Insert assembly into the wall opening and glue the inside surround in place.

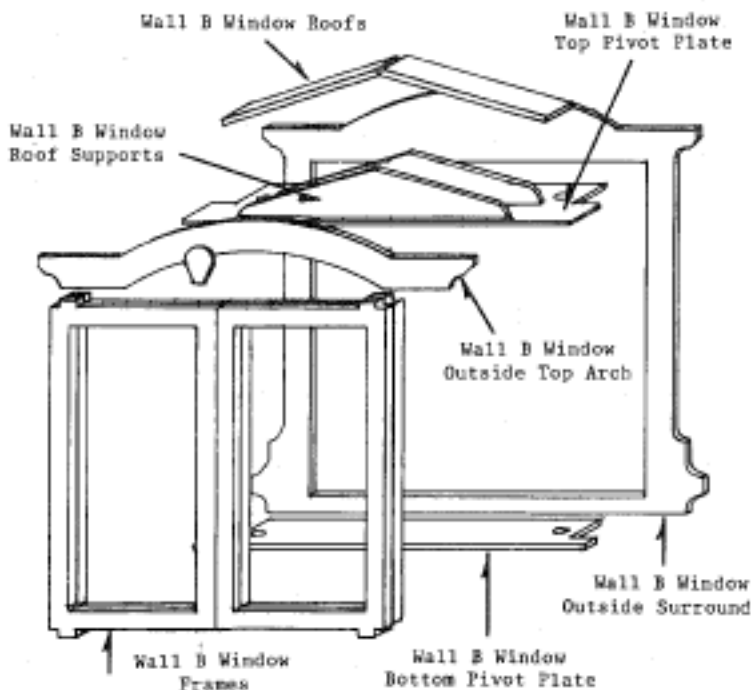

Figure 24

### WALL "D" SWINGING WINDOW

1. Locate Wall "D" window parts (Sheets CA-14,24).
2. Cut out "Wall 'D' Swinger" window glass.
3. Assemble as in Figure 24.

### WALL "F" BALCONY DOOR

1. Locate Wall "F" Door parts (Sheets CA-15,16).
2. Cut out "Balcony Door" window glass.
3. Assemble same as Front Door, except the glass gets sandwiched between the inside and outside wall F door panels.

### PORCH ARCHES AND PORCH RAILS

1. Locate Left, Right Front, and Right Side Porch Arches (Sheets CA-17,24).
2. Locate Porch Front and Porch Side Rails (Sheet CA-19).
3. Locate Porch Squares and Half Squares (Sheet CA-17).
4. Locate the two Porch Posts (Part No. 5-37).
5. Using Universal Trim (Part No. 5-70), cap all edges of the Porch Rails. Figure 25.

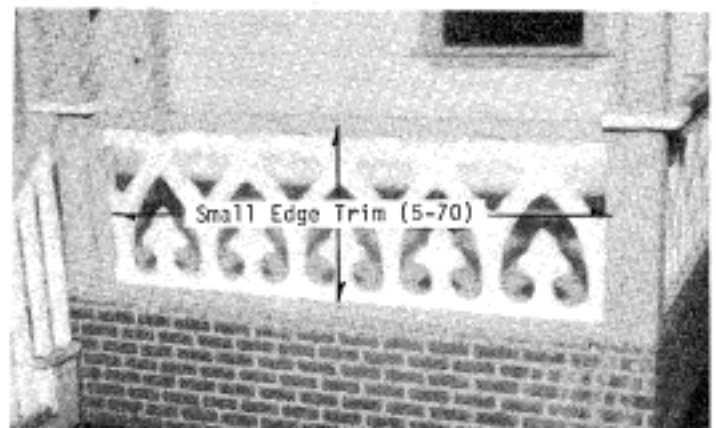

Figure 25

6. Assemble Porch Arches, Rails, Posts, and Squares as in Figure 26. Notice the ends of the rails and arches are centered on the posts.

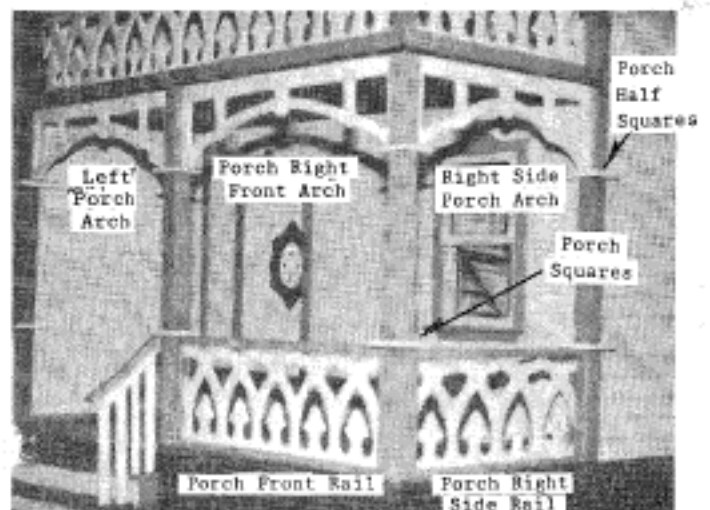

Figure 26

## FRONT STEPS

1. Locate the Front Step parts (Sheets No. CA-7,30).
2. Assemble as in Figure 27.

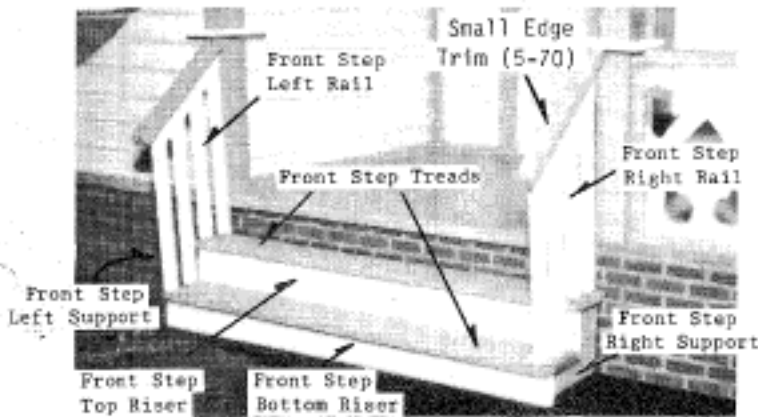

Figure 27

3. Glue to the base as in front view (you may wish to scrape away some brick for a better glue connection).

## FRONT BALCONY RAIL

1. Locate Porch Balcony Front Rail and Porch Balcony Side Rail (Sheets CA-22,30).

2. From the Small Corner Post (Part No. S5-2) Cut:  
1 - 2 3/4" length.

3. Using Small Edge Trim (Part No. 5-70), Cap the top, bottom, and ends of the front balcony rail assembly. Use the 2 3/4" Small Corner Post (S5-2) to connect the front rail to the side rail. Figure 28.

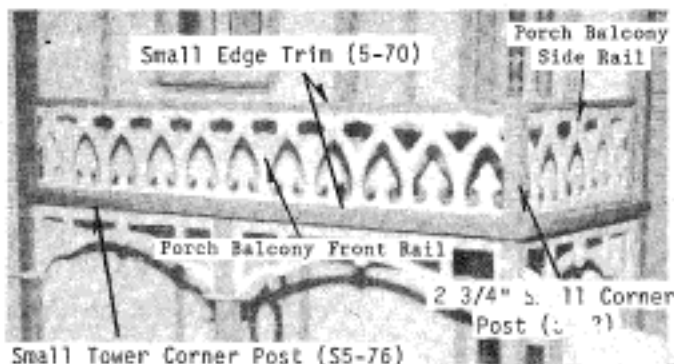

Figure 28

3. Trim the outside edges of the Porch Balcony Floor with Small Tower Corner Post (Part No. S5-76).

## LEFT BALCONY RAILS

1. Locate the Bay Balcony Front Rail, Left Rail, and Back Rail (Sheets CA-6,25,26).

2. From the Small Tower Corner Post (Part No. S5-76) Cut:

6 - 2 3/4" Lengths *cut 2 more*

3. Assemble 4 of the S5-76 pieces together to get two assemblies just like the Bay posts. See Figure 9.

4. Cap the top and bottom of the rails with Small Edge Trim (Part No. 5-70).

5. Assemble the Left Balcony Rail as in Figure 29.

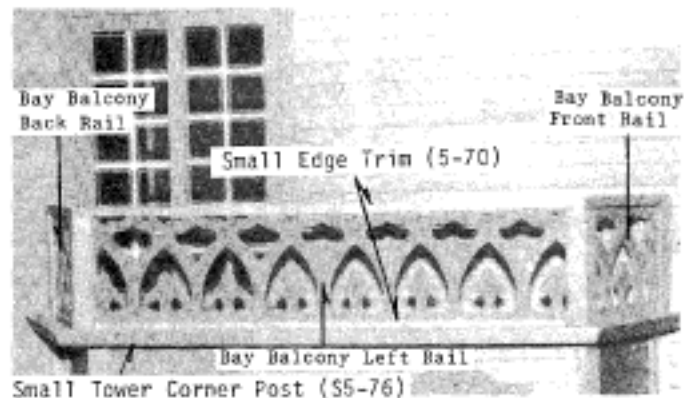

Figure 29

6. Trim the edge of the Left Balcony with Small Tower Corner Post (Part No. S5-76).

## 1ST STORY STAIRCASE

1. Locate 11 Staircase Treads, 1 Bottom Staircase Tread, 1st Story Staircase Banisters, and 1st Story Staircase Supports (Sheets CA-2,3,13,27).

2. Glue the tabs on the ends of the Supports into the slots in the 2nd Story Floor.

3. Glue the tabs on the bottom step of the supports into the Bottom Staircase tread.

4. Glue Supports to Floor. Glue Staircase Treads onto Support.

5. Before installing the 1st story banister, add Small Edge Trim (5-70) to the edges for a handrail. Figure 30.

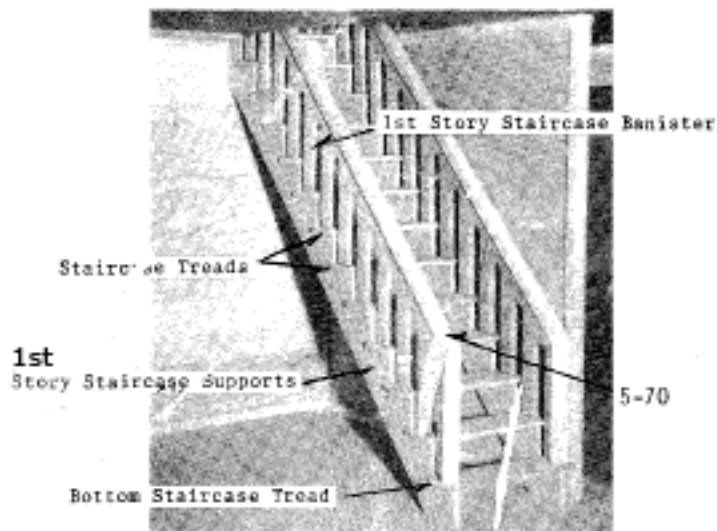

Figure 30

#### 2ND STORY STAIRCASE

1. Locate remaining 11 Staircase Treads, Bottom Staircase Tread, 2nd Story Staircase Banisters, and 2nd Story Staircase Supports (Sheets CA-13,28,30).
2. Assemble same as 1st Story Staircase.

#### 1st Story Room Partitions

1. Locate 1st Story Diagonal Room Partition (Sheet CA-25).
2. Use Small Edge Trim (5-70) around the inside of the opening.
3. Install as in Figure 31. Position notches in top of partition under 2nd floor splices.



Figure 31

4. Locate the 1st Story Staircase Room Partition (Sheet CA-26).
5. This part is 9 3/4" tall. Use Small Edge (5-70) to cover the side edges before installing.
6. Install as in Figure 32.



Figure 32

#### 2ND STORY ROOM PARTITIONS

1. Locate 2nd Story Staircase Room Partition and 2nd Story Main Room Partition (Sheets CA-23,24).
2. These Partitions are also 9 3/4" tall. Use Small Edge Trim to cover the edges of the sides and the doorway. See Figure 37.

#### MANSARD EAVES

1. Locate the Left, Right, and Middle Mansard Eaves (Sheets CA-9,10,14).
2. Glue tabs into grooves (no splice pieces) as in Figure 33.

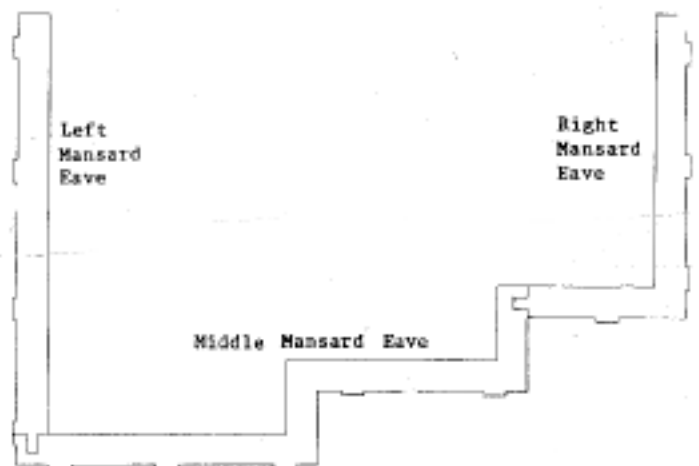

Figure 33



## MANSARD ROOF

1. Locate Main Mansards A, B, C, D, E, F, G, Right Back Mansard Support (For G), and Left Back Mansard Support (For A), Sheets CA-15,16,17,18 Before removing Mansards from sheets, tape a few strips of tape to the bad side of the Mansards to make sure the Mansards stay together as one piece.

2. Transfer the cut lines from the good side to the bad side. These lines will be redwood shake guide lines. The smooth sides go inside. Rough sides will be covered with shakes.

3. Tightly assemble Mansards by interlocking notches on the edges of the Mansards and interlocking Mansards to the Mansard Eaves as in Figure 34. Flex the Mansard roof pieces so the score lines in the good side open a little more. Use lots of tape and glue. The bad side of the Mansard goes to the outside.

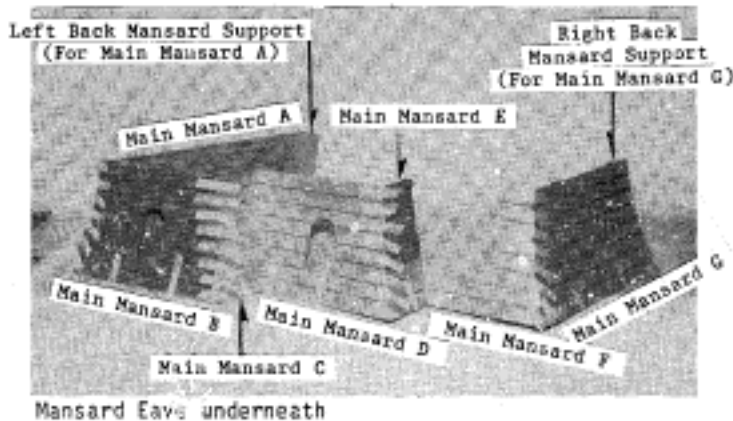

Figure 34

## 3RD STORY ROOF

1. Locate 3rd Story Left Side, Right Side, and Middle Roofs, and 3rd Story Roof Splices (Sheets CA-2,11,12,13).

2. With the good side down, splice roofs together as in Figure 35. Cut 1/8"x1/8" notch as indicated.

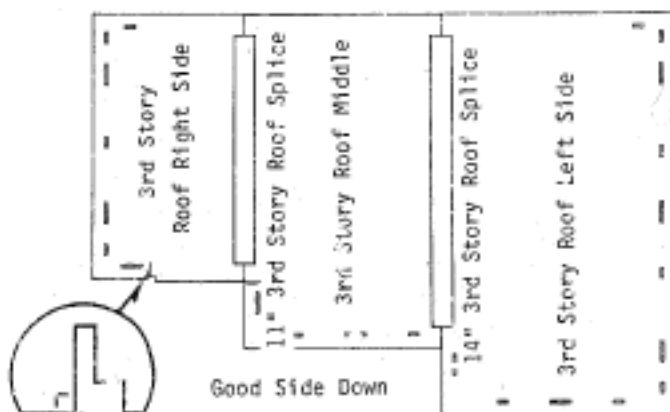

Figure 35

Cut 1/8"x1/8" Notch

3. Install 3rd Story Roof onto the top of the Main Mansard assembly by gluing Main Mansard top tabs into the slots in the 3rd Story Roof.

## TOWER

1. Locate Mansards T1, T2, T3, T4, Tower Roof, and Tower Roof Eave (Sheets CA-14,18,19,20,21).

2. Assemble just like Main Mansard. [Position note]

3. Locate Tower Walls T1, T2, T3, and T4 (Sheet CA-22).

4. From the Small Corner Post, S5-2, cut:

- 3 - 3 1/4" lengths
- 1 - 7 3/4" length

5. Assemble the walls as in Figure 36.

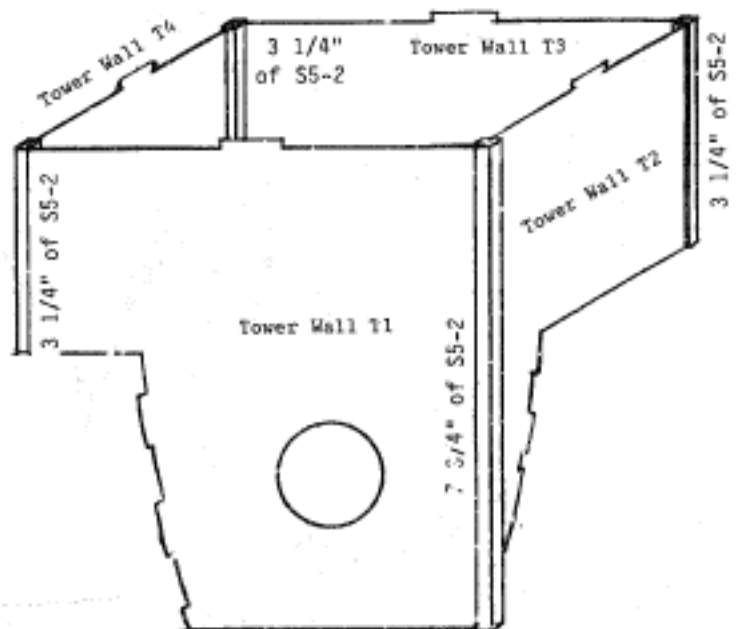

Figure 36

6. Glue the tabs on the tops of the walls into the slots on the underside of the Tower Eave. The window on Tower Mansard T1 is on the same side as the Tower Wall T1.

7. Glue the Tower assembly to the Main Mansard assembly by interlocking tabs on Tower Wall T1 with Main Mansard tabs on Mansards E and F, and by gluing the other tower walls to the 3rd Story Roof.

## ROOF TRIM

1. Locate Roof Trim and Tower Roof Trim pieces (Sheets CA-5,8,11,13,18,20,23,30). You may want to remove the roof trim pieces alphabetically and numerically as you install them for identification purposes. The Walls, Mansards, Roof Trim, and Bracket Plates all have corresponding identification letters. See Figure 34.

2. Install Chimney in the gap between Roof Trim A1 and Roof Trim A2.

3. Using the Small Tower Corner Post (Part No. S5-76) cover the edges all the way around the 3rd Story Roof and the Tower Roof.

## MANSARD EAVE SUPPORT

1. From the 1/4"x1/2" Stock (Part No. 5-147) cut:

- |     |                 |                     |
|-----|-----------------|---------------------|
| 1 - | 18 1/8" length  | (For Wall A)        |
| 1 - | 10 5/8" length  | (For Wall B)        |
| 2 - | 2 5/8" lengths  | (For Walls C and E) |
| 1 - | 8 5/8" length   | (For Wall D)        |
| 1 - | 6 1/2" length   | (For Wall F)        |
| 1 - | 11 9/16" length | (For Wall G)        |

2. Glue these pieces to the inside top of the corresponding walls. Make the tops of the 1/4"x1/2" pieces flush with the tops of the large corner posts.

## BRACKET PLATES

1. Locate Bracket Plate A, Plate B, Plate C, Plate D, Plate E, Plate F, Plate G, Tower Bracket Plate T1, Plate T2, Plate T3, and Plate T4 (Sheets CA-12,13,22,30).

2. Locate the Brackets (Part No. 5-141).

3. Lay Bracket Plate A in a drawer with the good side up. Push it against a side. Glue Brackets to the Bracket Plate on the Bracket Placement Marks.

4. Glue Bracket Plates to the appropriate walls so the tops of the plate are the same height as the 1/4"x1/2" pieces.

5. Glue Mansard Eaves to the tops of the 1/4"x1/2" pieces, Bracket Plates, and Brackets.

## 3RD STORY ROOM PARTITION

1. Locate 3rd Story Room Partition (Sheet CA-24).

2. Cover the side edges with Small Edge Trim before installing.

3. Glue in place as back view.

## 2ND STORY AND 3RD STORY STAIRWELL RAILS

1. Locate 2nd and 3rd Story Stairwell Rails (Sheets CA-10,11,12).

2. Assemble 3rd Story Stairwell Rails so the ends of the Side Rails Glue the side of the Front Rail.

3. Use Small Edge Trim to cap the top and ends of the rails.

4. Glue Rails in place as in Figure 37.

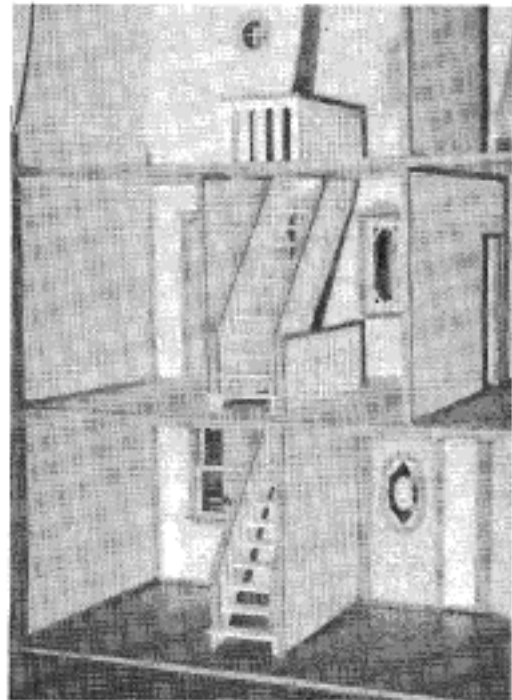

Figure 37

## TOWER WALL WINDOW

1. Locate Tower Wall Window Inside and Outside Surrounds (Sheet CA-26).

2. Cut out "Tower Wall" window glass.

3. Glue glass to the bad side of the outside surround.

4. Glue Surrounds to the inside and outside of the tower wall.

## DORMERS

1. Locate Dormer Frames, Outside Surrounds, Sills, Roof Wraps (Partially Cut), Arms, and Inside Surrounds (Sheets CA-15,16,18,24,28,30).

2. Cut out "Dormer" window glass.

3. Glue the glass to the bad side of the Dormer Frame. Tape the bad side of the Dormer Roof Wrap before removing it from the sheet.
4. Assemble Dormer as in Figure 38.

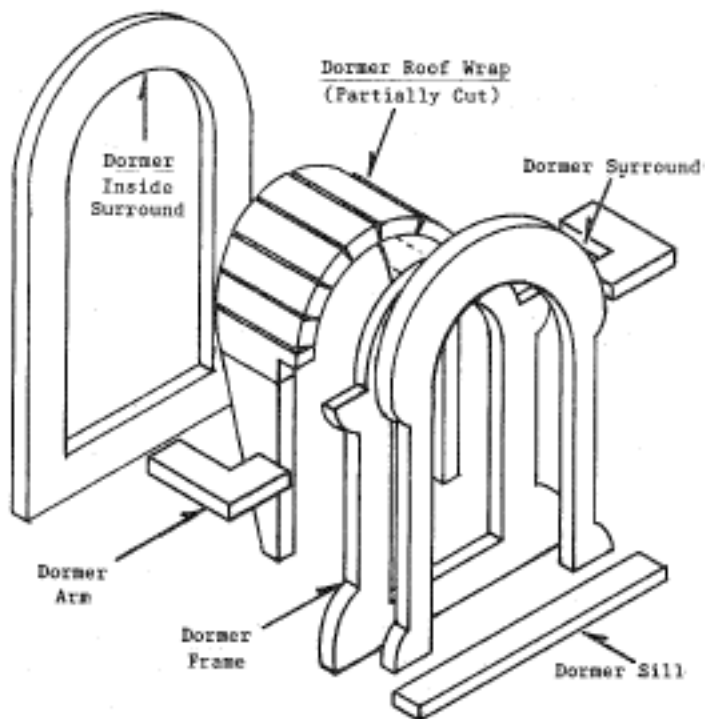

Figure 38

5. Glue Dormers to Mansard window openings.

#### TOWER DORMERS

1. Locate Tower Dormer Outside Surrounds, Roof Wraps, Sills, Arms, and Frames (Sheets CA-27,30).
2. Cut out "Tower" window glass.
3. Assemble Same as previous Dormers.
4. Glue to the Tower Mansard window openings.

#### GUTTERS AND DOWNSPOUT

1. Cut 1/4"x1/4" molding (Part No. 5-46) to fit flush under the outer edge of the Main Mansard (only) all the way around. Figure 39.

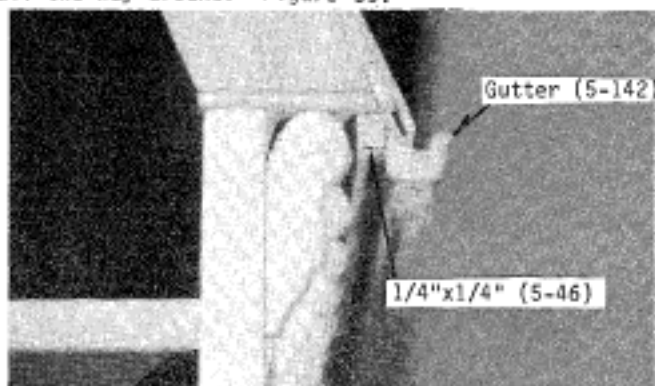

Figure 39

2. Cut Gutter (Part No. 5-142) to fit around the outside of the 1/4"x1/4" molding flush with the bottom of the Mansard Roof. Figure 39.

3. Locate Gutter Caps (Sheet CA-14): Glue to the ends of the Gutters at the back of the house.

4. Add Downspout (Part No. 5-143) to the gutter. Figure 40.

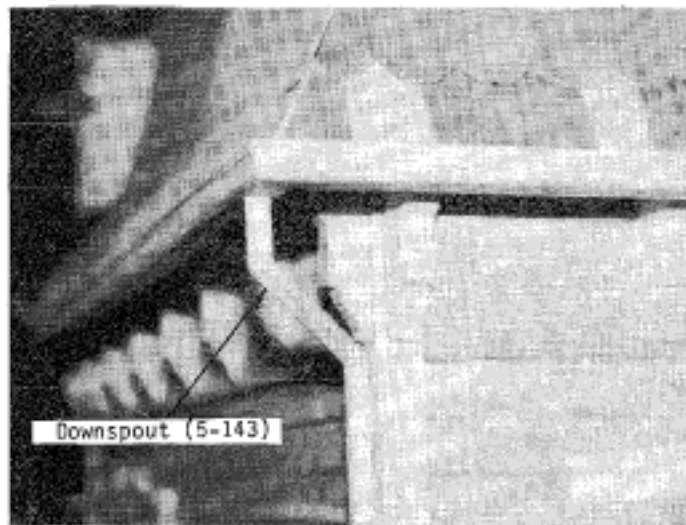

Figure 40

#### REDWOOD SHAKES

1. Glue the shakes on the Mansard Roof and Tower Mansard Roof starting from the bottom and working up. Align the top edges of each row of shakes with the lines you drew earlier. The rows should be staggered so that each shake covers a portion of the two shakes below. See front view for fancy and plain shake placement.
2. Cut the shakes to the appropriate angles where needed with a sharp knife.
3. Add redwood trim (Part No. 5-19) around the chimney.

#### TRIM

1. Using the Universal Trim (Part No. 5-3), trim the inside and outside base/wall junctions, all floor/wall junctions, the top of the base bricks, and the wall/roof junctions. See front, back and side views.

EACH PART IS HELD IN THE BOARD BY NOTCHES, THESE NOTCHES  
MUST BE CUT BEFORE REMOVING PARTS FROM THE BOARD.



SHEET CA-1



SHEET CA-2

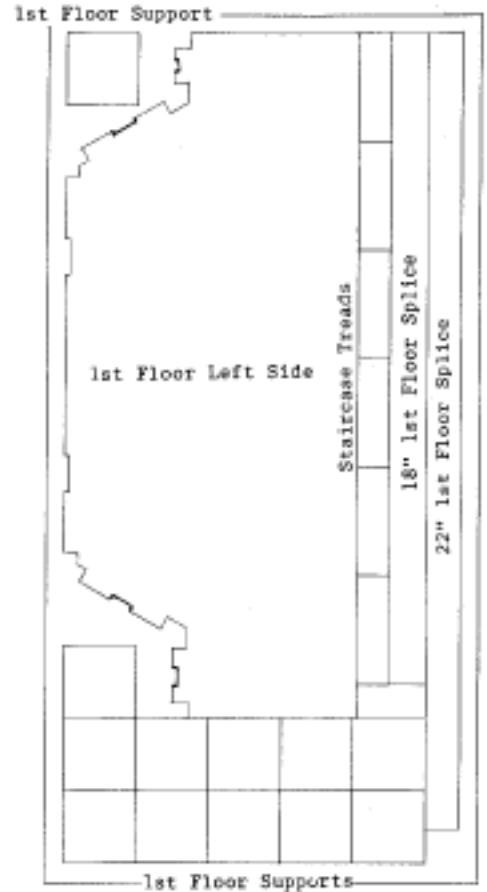

SHEET CA-3

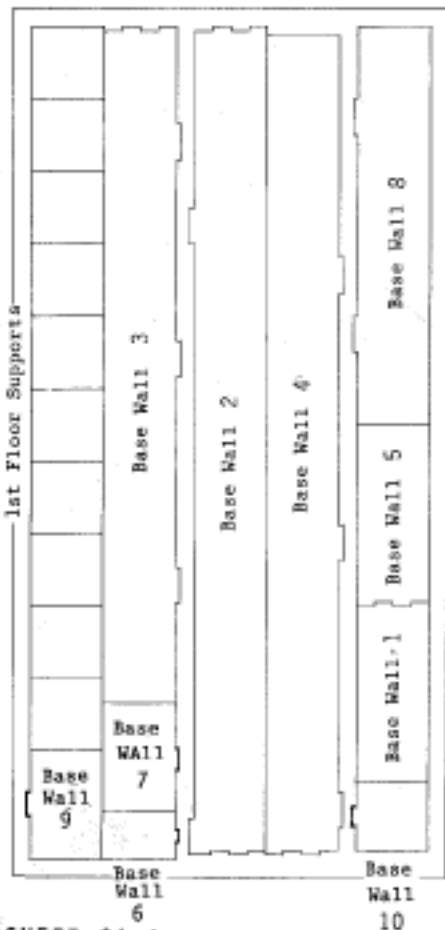

SHEET CA-4  
CA 750 Page 20

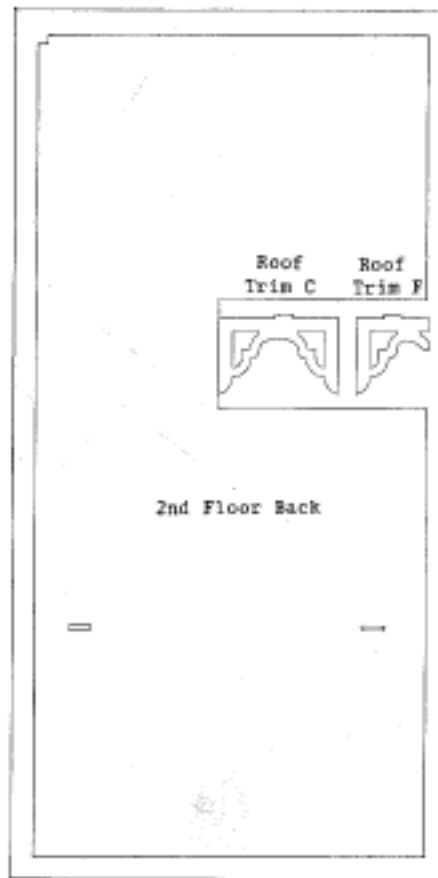

SHEET CA-5

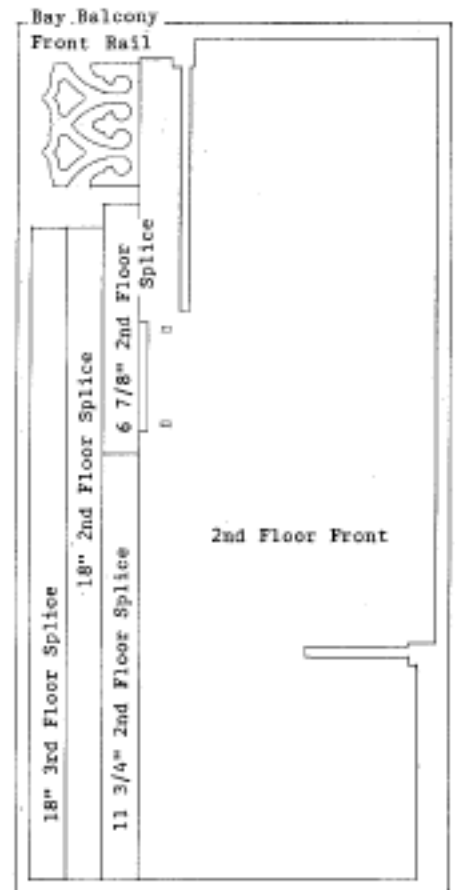

SHEET CA-6

EACH PART IS HELD IN THE BOARD BY NOTCHES, THESE NOTCHES  
MUST BE CUT BEFORE REMOVING PARTS FROM THE BOARD.

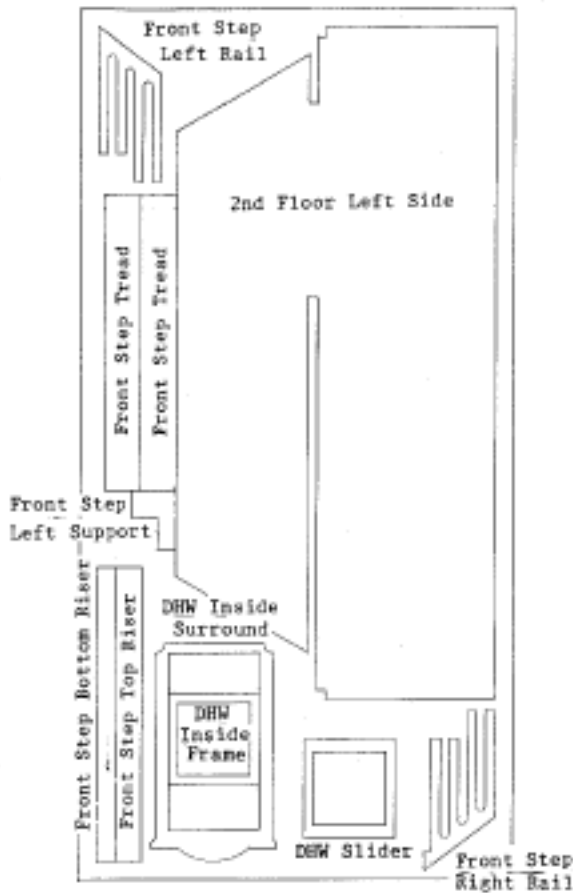

SHEET CA-7



SHEET CA-8

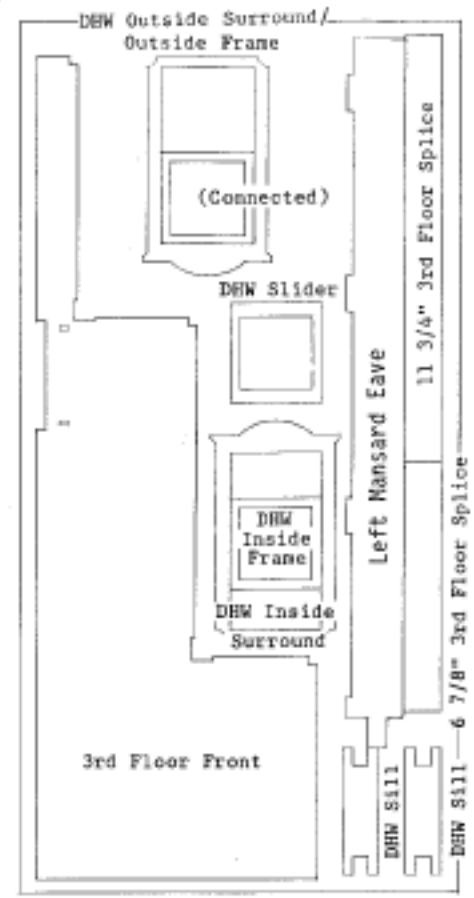

SHEET CA-9

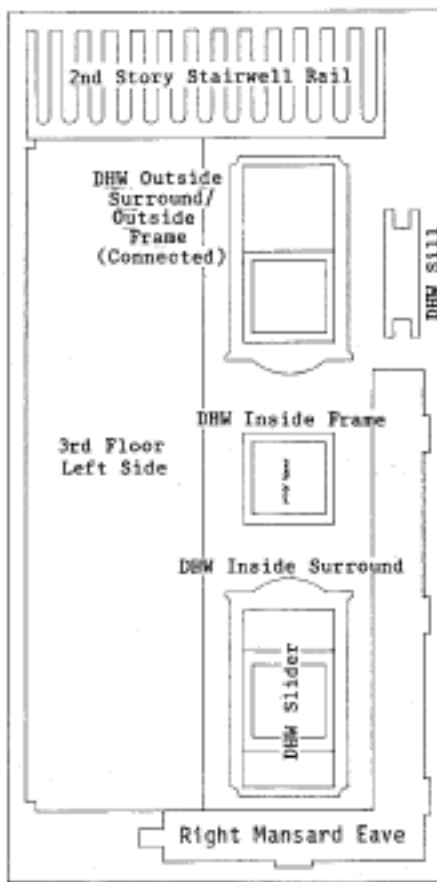

SHEET CA-10

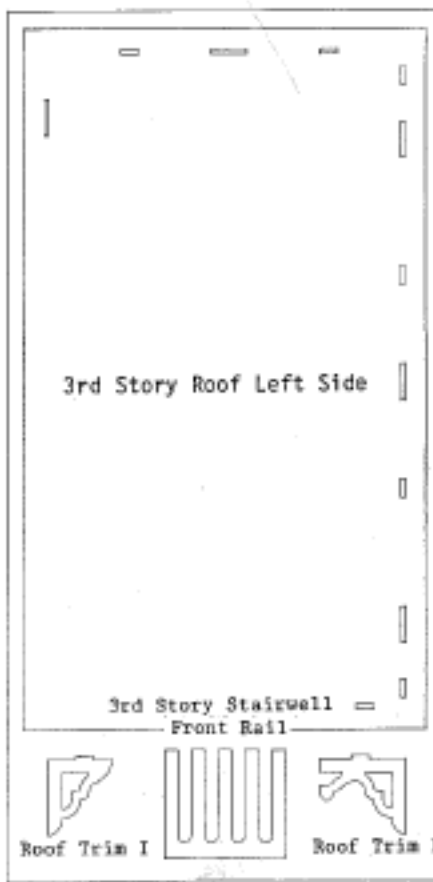

SHEET CA-11

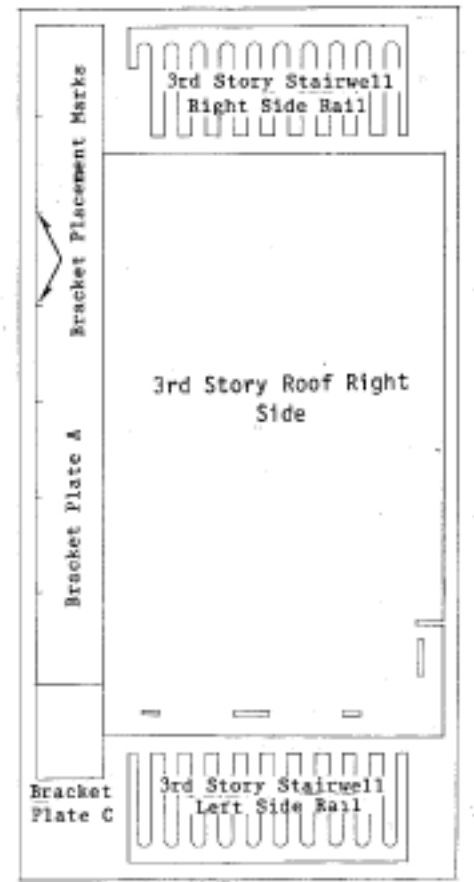

SHEET CA-12

EACH PART IS HELD IN THE BOARD BY NOTCHES, THESE NOTCHES  
MUST BE CUT BEFORE REMOVING PARTS FROM THE BOARD.

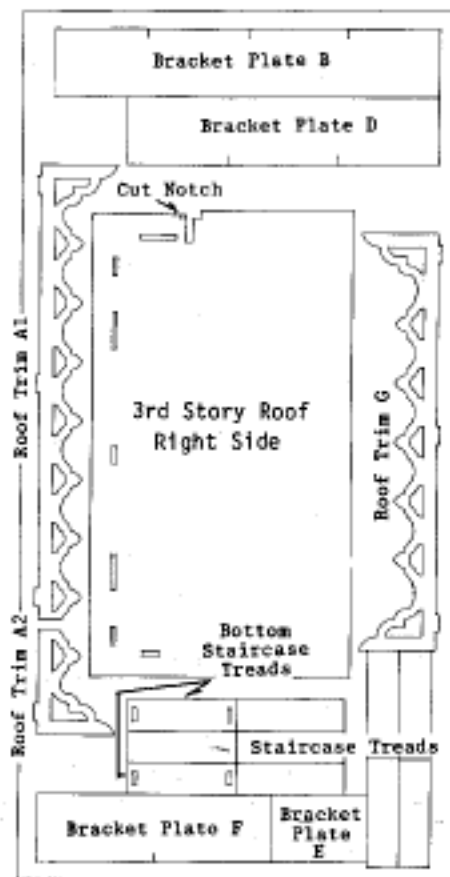

SHEET CA-13



SHEET CA-14

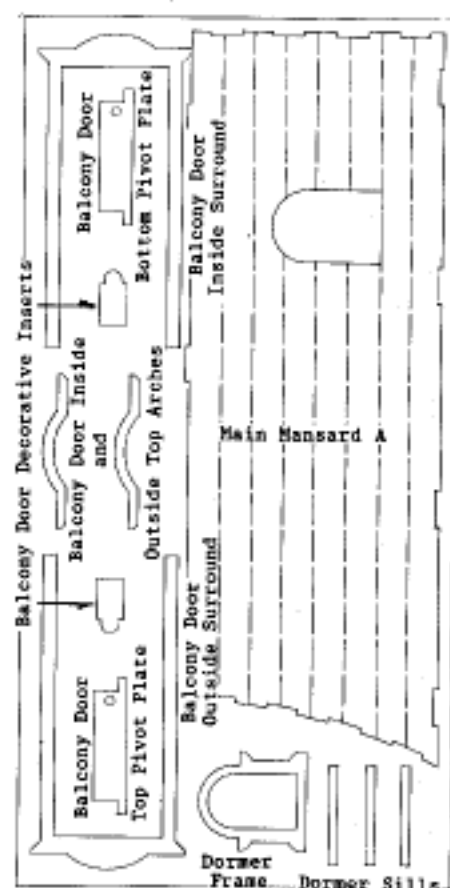

SHEET CA-15

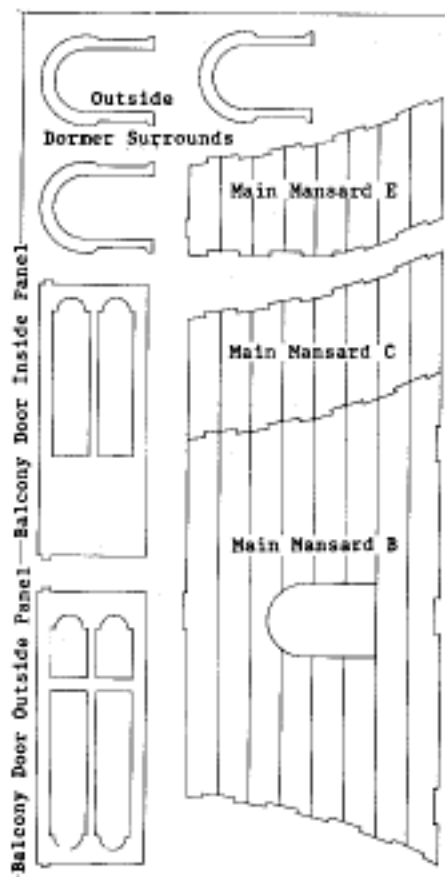

SHEET CA-16

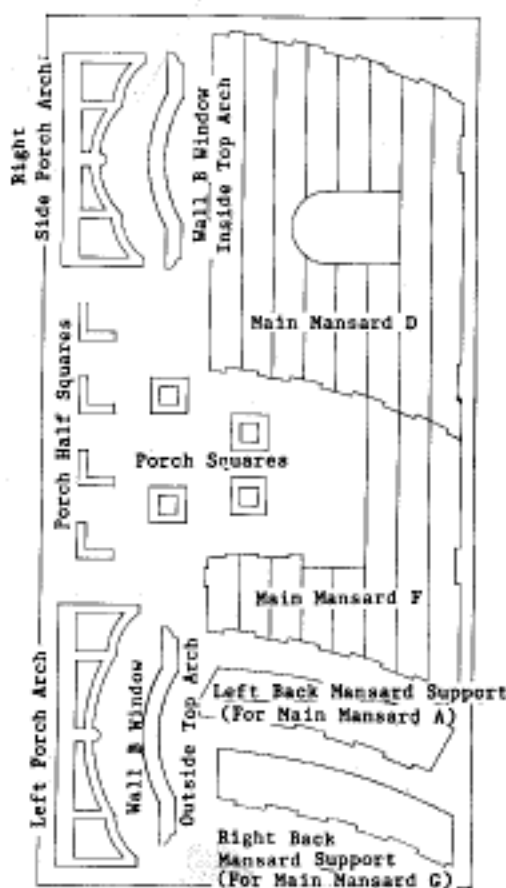

SHEET CA-17

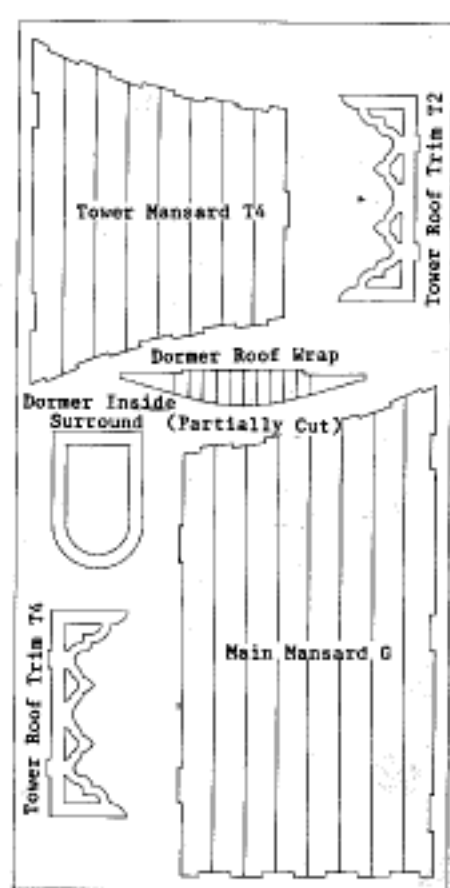

SHEET CA-18

EACH PART IS HELD IN THE BOARD BY NOTCHES, THESE NOTCHES  
MUST BE CUT BEFORE REMOVING PARTS FROM THE BOARD.

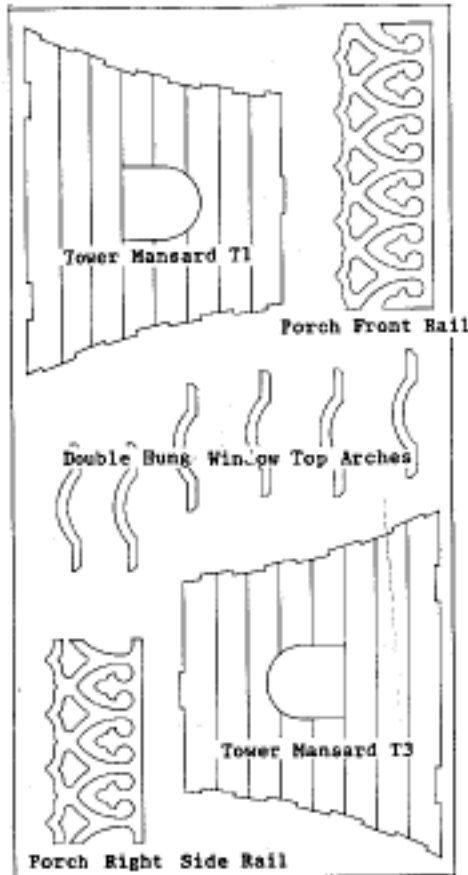

SHEET CA-19

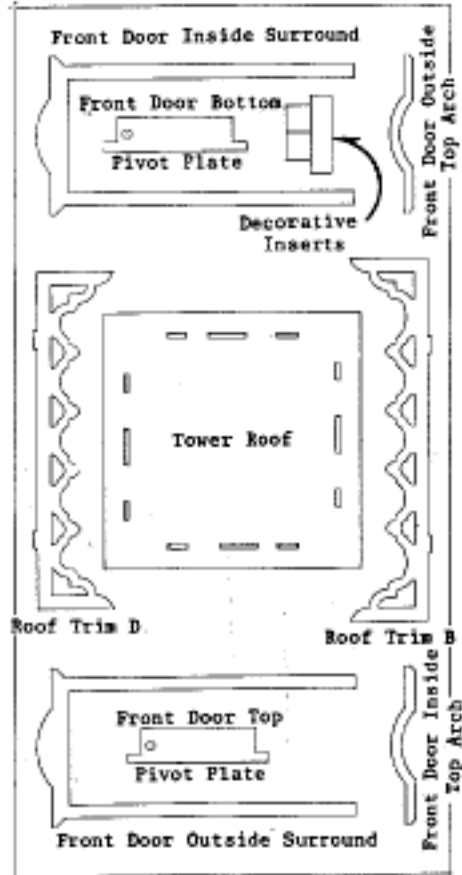

SHEET CA-20

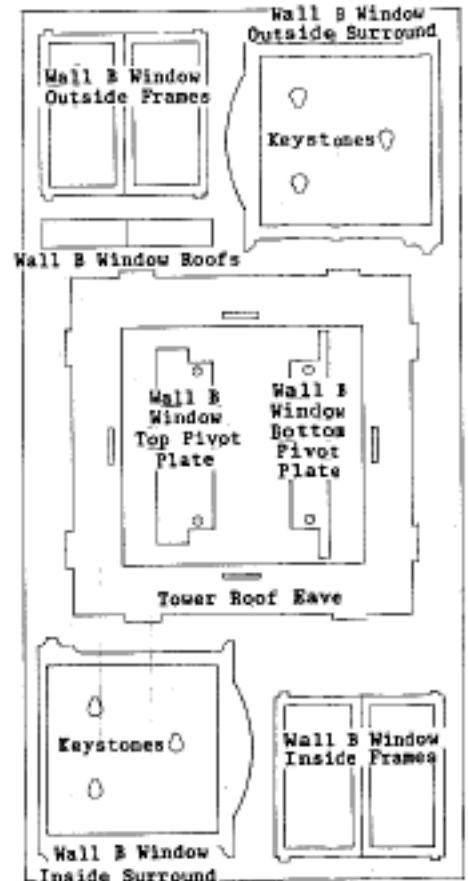

SHEET CA-21

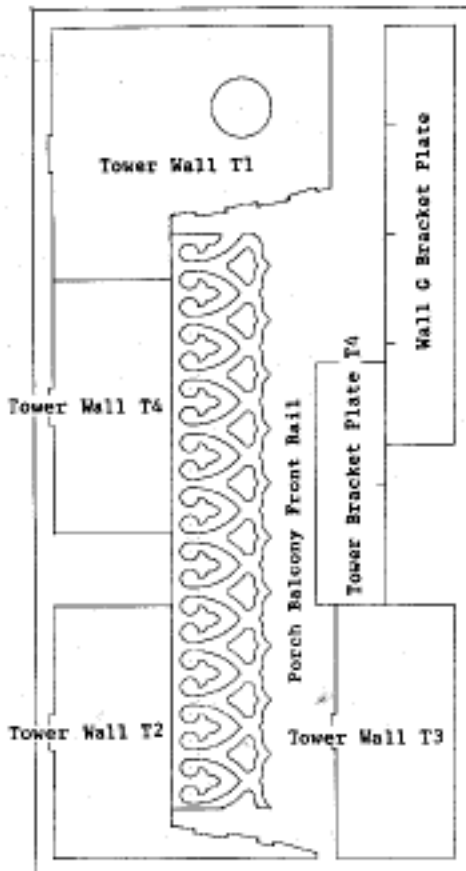

SHEET CA-22

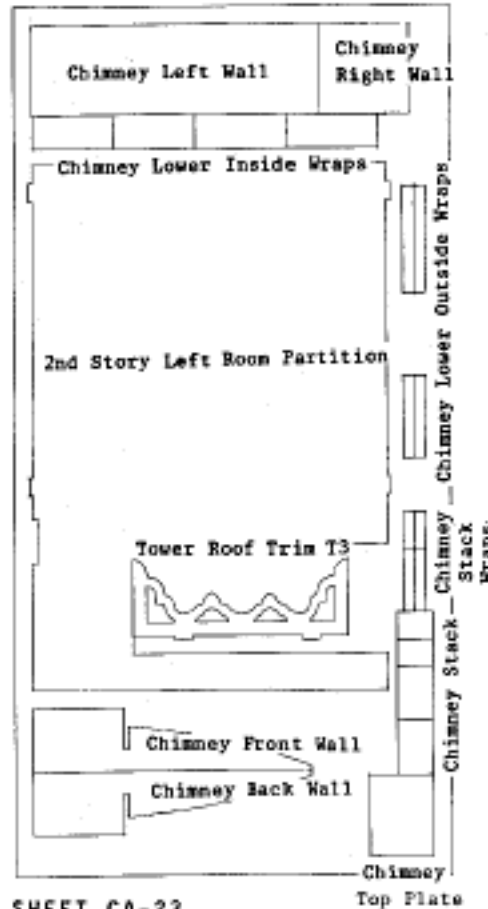

SHEET CA-23

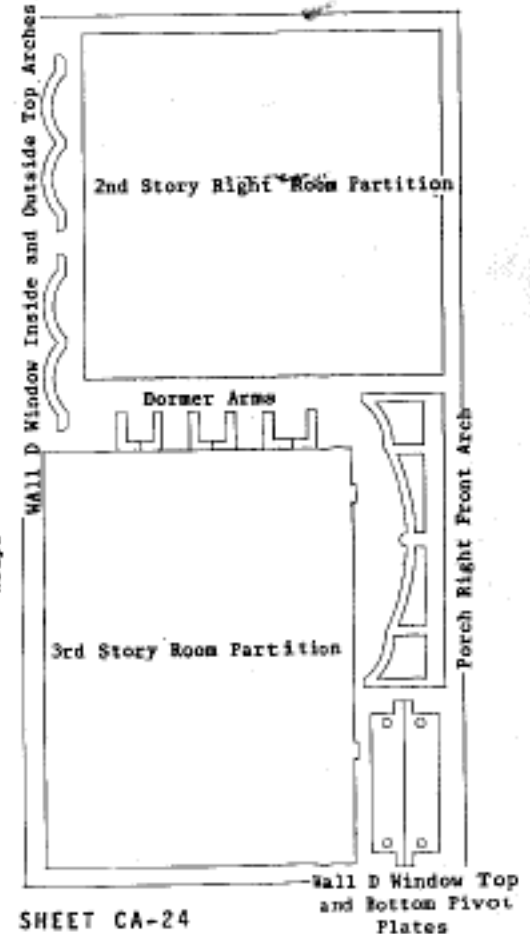

SHEET CA-24

EACH PART IS HELD IN THE BOARD BY NOTCHES, THESE NOTCHES  
MUST BE CUT BEFORE REMOVING PARTS FROM THE BOARD.

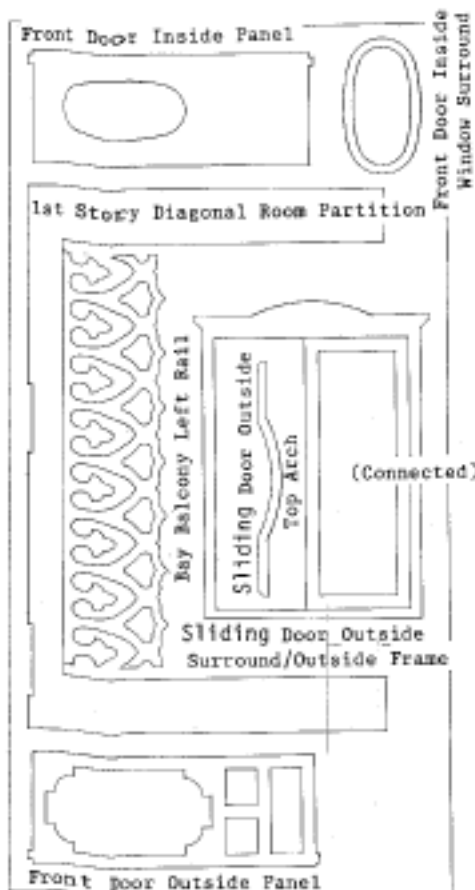

SHEET CA-25

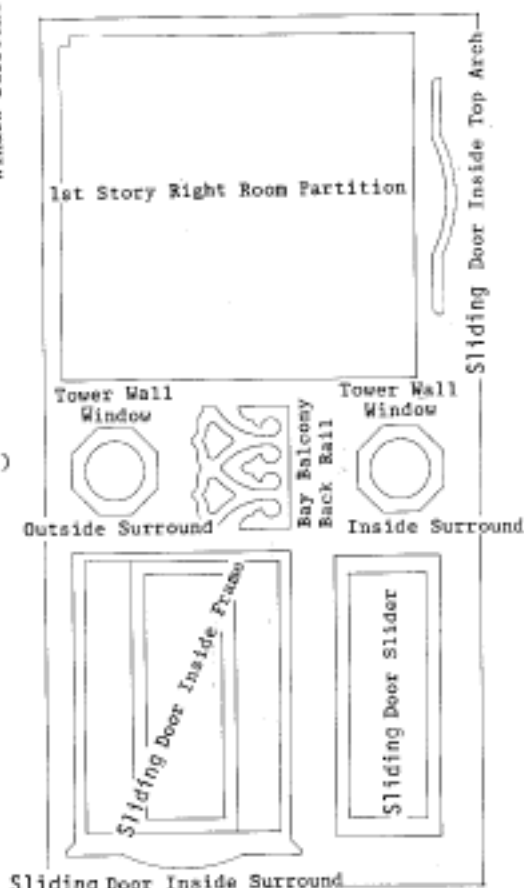

SHEET CA-26

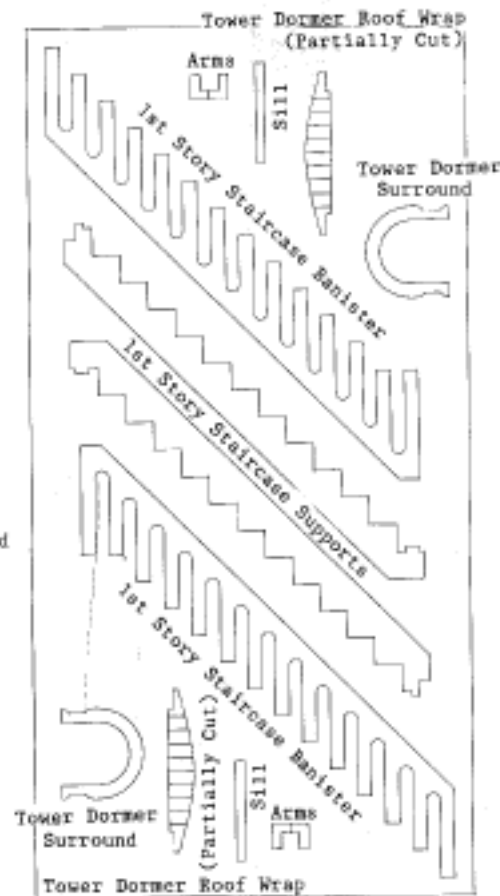

SHEET CA-27

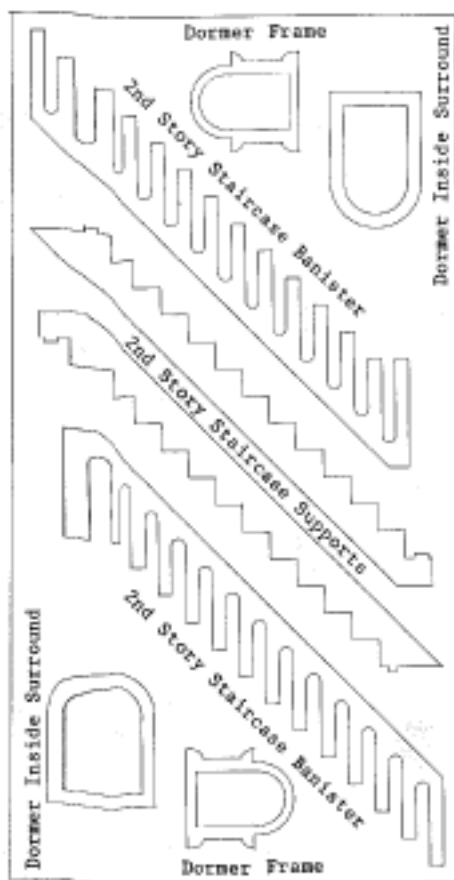

SHEET CA-28  
CA 75 Page 24

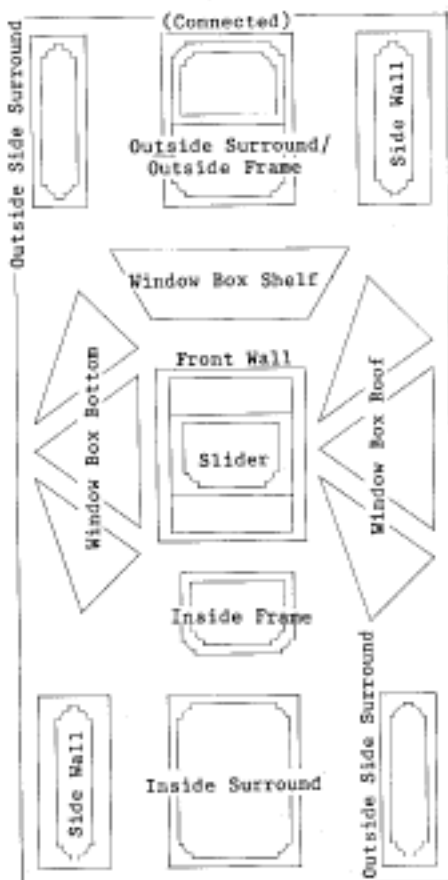

SHEET CA-29



SHEET CA-30



### MISSING AND BROKEN PARTS REPLACEMENT FORM

While we have done our very best to make sure that the kit you have purchased is complete and accurate, sometimes something goes wrong. We may have forgotten a piece, parts might have been damaged in freight, or you may have assembled it wrong. Dura-Craft policy has always been to replace parts at no charge, postage prepaid, no matter who was at fault. But please, for our records only, mark one of the following:

MISSING      DAMAGED      ASSEMBLED WRONG

Name \_\_\_\_\_  
 Address \_\_\_\_\_  
 City, State \_\_\_\_\_ Zip \_\_\_\_\_  
 Phone( \_\_\_\_\_ ) \_\_\_\_\_

Return this form to: DURA-CRAFT, INC.  
P.O. BOX 438, NEWBERG, OREGON 97132

PLEASE USE THIS FORM FOR FAST AND ACCURATE SERVICE

Building	Sheet No.	Quantity	Name of Part

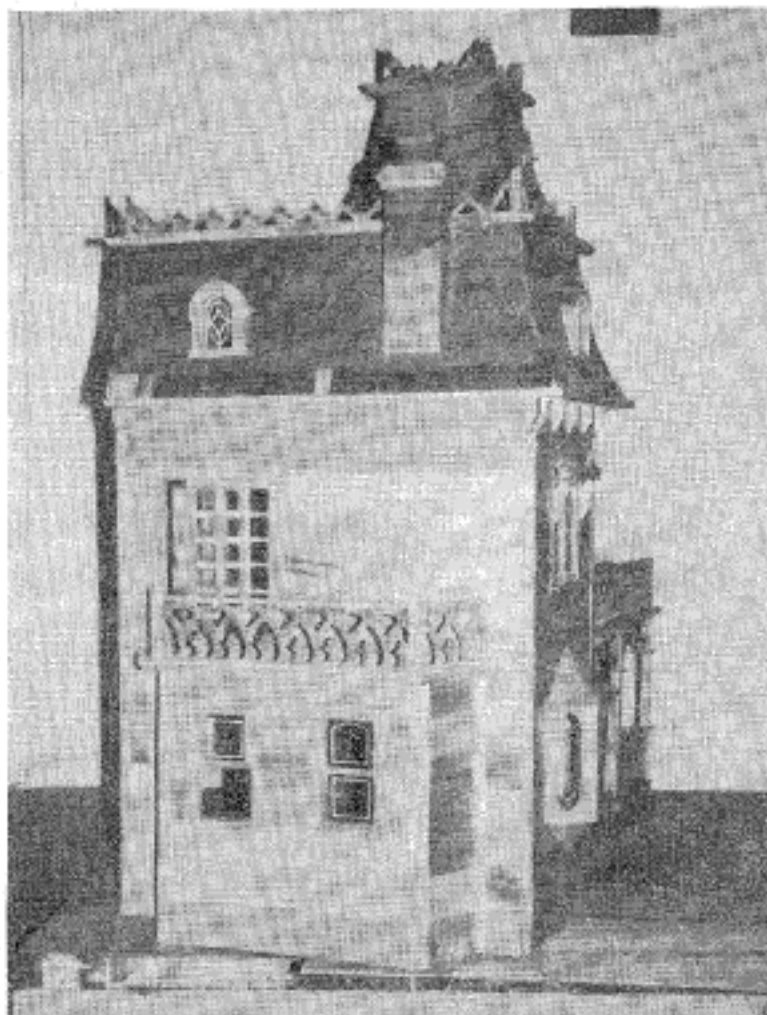

Left Side View

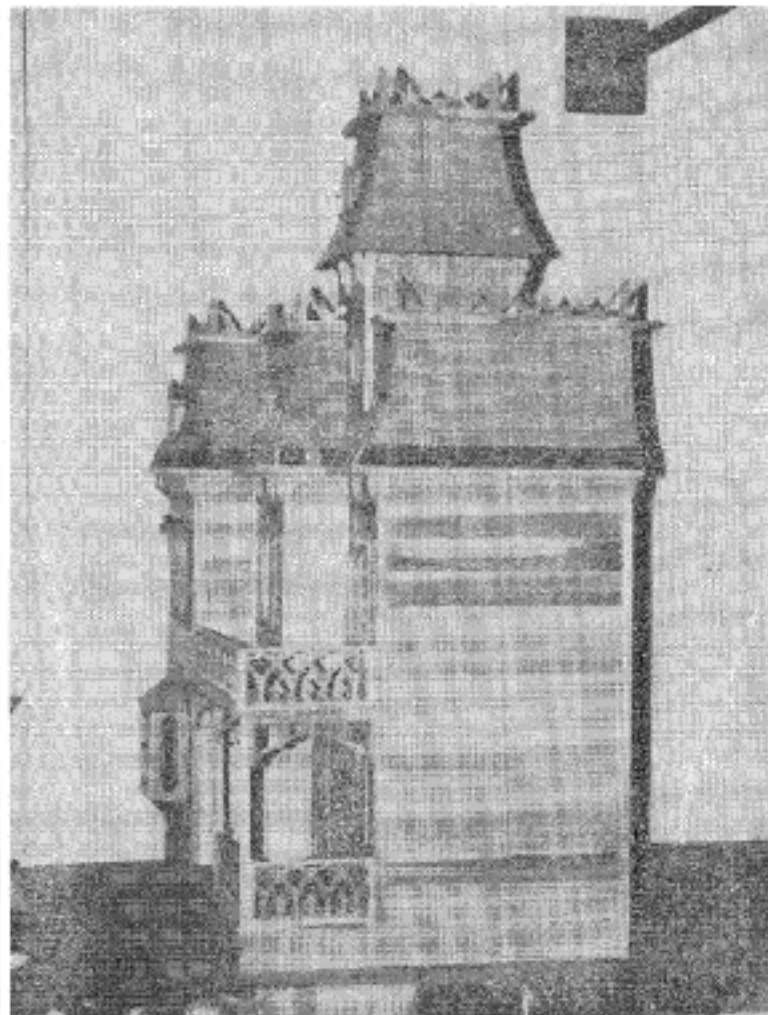

Right Side View

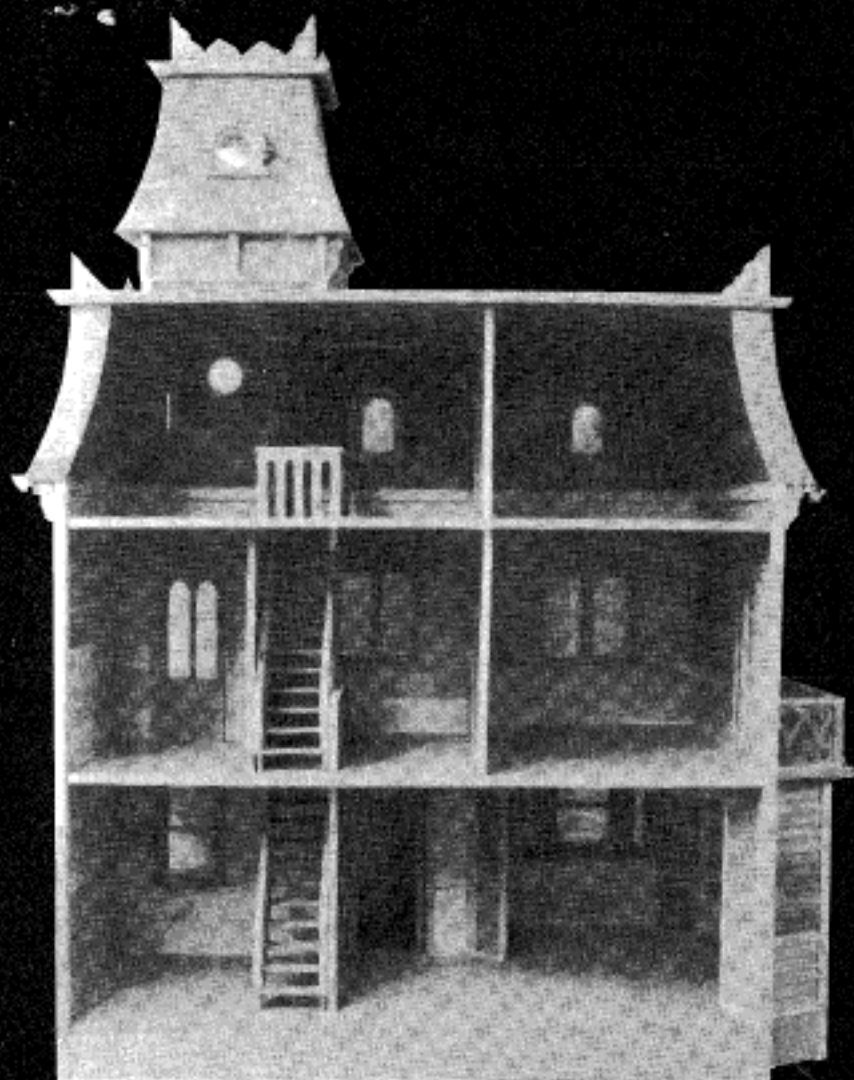

#### **WARRANTY**

##### **Buy this kit with confidence!**

Dura-Craft, Inc. will guarantee each purchase with the necessary service and assistance to satisfactorily complete this kit. Damaged or missing parts will be replaced even if the damage is caused by improper assembly. This assistance will be supplied at no additional cost.

***Dura-Craft, Inc.***  
P.O. Box 438  
Newberg, OR 97132  
(503) 538-3136