

Parts List:

- (1) Assembly Instructions
- (1) Front Roof: $(\frac{3}{8}) 24\frac{7}{8} \times 12\frac{7}{8}$
- (1) Rear Roof: $(\frac{3}{8}) 24\frac{7}{8} \times 2$
- (2) Eave: $(\frac{3}{8}) 2 \times 10\frac{1}{2}$
- (2) Side Panel: $(\frac{3}{8}) 27\frac{1}{16} \times 15\frac{7}{8}$, grooves
- (1) Front Panel: $(\frac{3}{8}) 19\frac{1}{8} \times 23\frac{7}{8}$, cutouts
- (2) Blank Floor: $(\frac{3}{8}) 23\frac{3}{8} \times 15\frac{7}{8}$
- (1) Mid Floor: $(\frac{3}{8}) 23\frac{3}{8} \times 15\frac{7}{8}$, stairway cutout
- (2) Attic Partition: $(\frac{3}{8}) 7\frac{15}{16}$ tall
- (3) Divider: $(\frac{3}{8}) 9 \times 15\frac{7}{8}$, door cutout
- (1) Bathroom Divider: $(\frac{3}{8}) 9 \times 4\frac{1}{2}$, door cutout
- (2) Divider: $(\frac{3}{8}) 9 \times 2\frac{5}{8}$
- (2) Foundation: $(\frac{3}{8}) 23\frac{1}{2} \times 1\frac{3}{4}$
- (3) Foundation: $(\frac{3}{8}) 15\frac{5}{16} \times 1\frac{3}{4}$
- (1) Front Step: $(\frac{3}{4}$ pine) $5\frac{1}{2} \times 2\frac{1}{8}$
- (1) Top Step: $(\frac{3}{4}$ pine) $5\frac{1}{2} \times 1\frac{1}{8}$

Assemble the housebody

1. Pre-punch three nail holes in each groove in the Side panels.
2. Select the Middle Floor panel and square the stairway cutout (Illustration #1). Without glue, test the Floor Panels along with the Sides to check the fit, and to identify the proper position of the stairhole (Illustration #2).

3. Spread glue in the grooves of one Side panel. Use plenty of glue and spread it lightly with your finger to keep it from dripping. (If the glue is too runny, wait a bit for it to tack.)

Now is a great time for an extra pair of hands.

4. Stand the middle floor on end (check the orientation again) and set the side panel over the floor in the middle groove. Repeat for the top floor (Blank Floor) in the top groove.

5. Adjust and check all the parts. The floors must be flush on the edges with the side panels ("flush" means 'forming a continuous, unbroken surface'). Nail through the pre-punched holes (Illustration #3).

6. Very Carefully turn the side/floor assembly over. Glue and nail the other Side panel to the upper floors.

7. Spread the sides slightly to set the base floor (Blank Floor) (best side up) into the base floor groove. Make extra-sure that the base floor is pressed to the top-edge of the groove while you nail through the pre-punched holes.

Illustration #1
Square the Corners

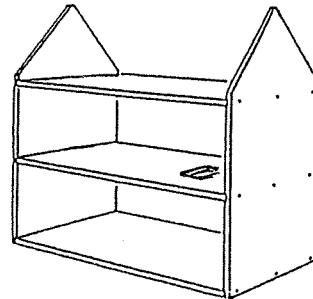
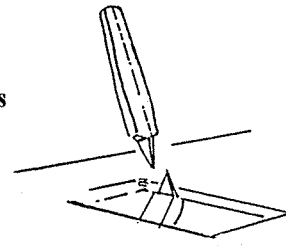

Illustration #2
Pre-punched Holes
Ready for Nailing

Base Floor Tight to the
Top of the Groove

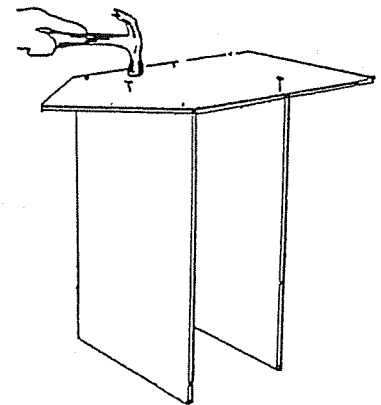
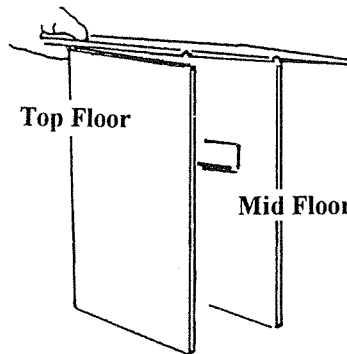
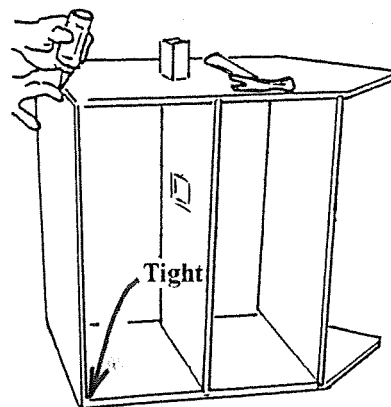

Illustration #3
Nail Through
Pre-punched Holes



Review: Make sure all parts are in place.

- Identify the front edge.
- Check the orientation of the floors
- Floors are flush with the sides.
- Base floor is tight to the groove-top.

Attach the Front to the House Body

8. Lay the house body on its **BACK** on a flat surface. Place Dividers between each floor near the center as locators for the center floor (Illustration #4).

Note: Temporary placement of Dividers will locate and stabilize the middle floor while attaching the front.

9. Glue and nail the Front panel to the house body. Focus on making the front flush along the entire bottom edge and along one side panel (Illustration #5). This process is your assurance of a straight house!

Finish nailing the front in place; hold down the top floor while nailing, and measure $9\frac{9}{16}$ (remember to check for split-out before the final hammer strike).

The house body is now complete.

Assemble and Attach the Foundation

1. Glue and nail together the foundation. The front and back overlap the sides and middle (Illustration #6).

2. Glue and weight, tape or nail the foundation set to the bottom of the house body base floor; spaced evenly at the sides and front, and flush at the back (Illustration #7).

Illustration #4

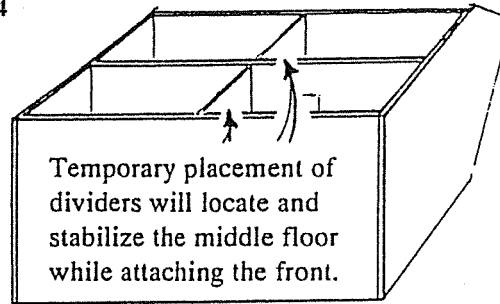

Illustration #5

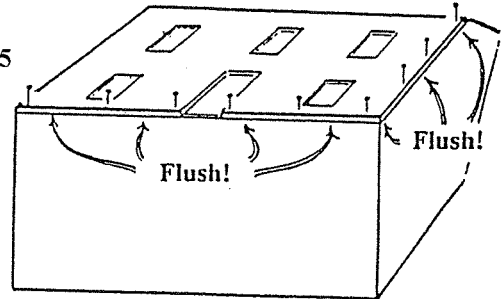

Illustration #7

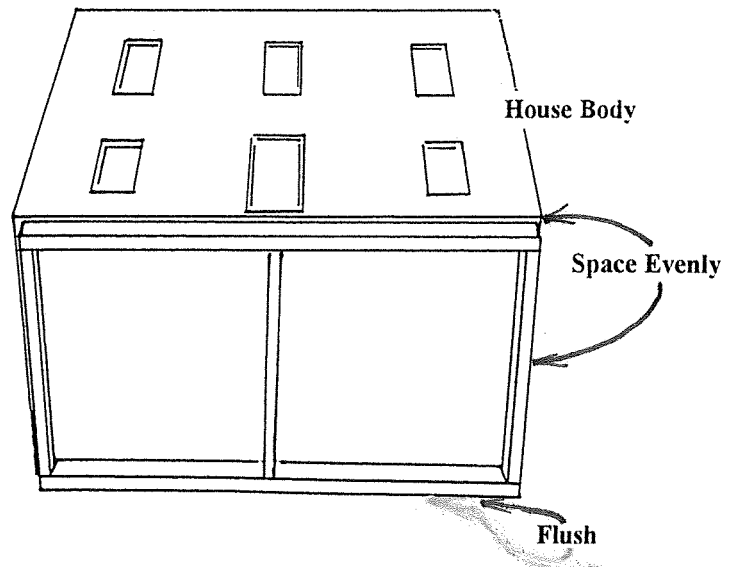
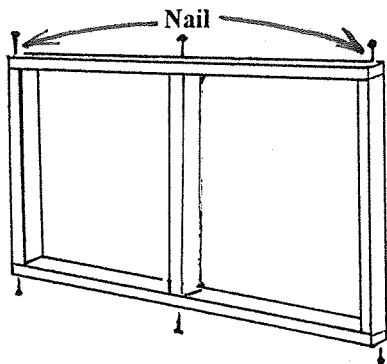

Illustration #6

Note:
Front/Back Overlaps
Sides/Middle



Assemble the Roof

1. (Illustration #8)

- Lay the Front Roof against the completed house body, centered side-to-side.
- Trace the sides of the house body on the Front Roof underside.
- Repeat the tracing procedure with the Rear Roof.

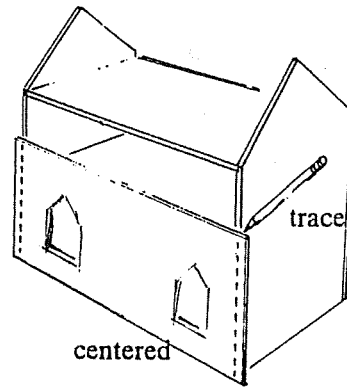

Illustration #8

2. Stand the Front Roof in place on the house body lining up the traced lines. Trace the thickness of the sides on the Front Roof and the Rear Roof.

3. (Illustration #9)

Pre-punch nail holes on center between the traced lines, one on each side for the Rear Roof, three on each side for the Front Roof (punch holes more than 1" from the top and 2 1/4" from the bottom of the Front Roof).

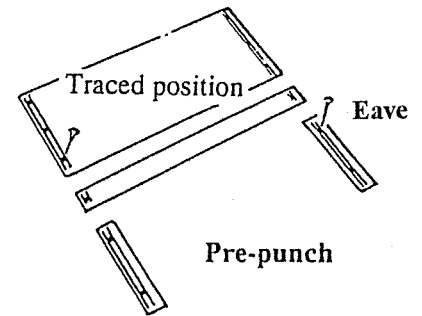

Illustration #9

4. Glue and nail the Rear Roof in place, carefully lined up with the traced lines (Illustration #10).

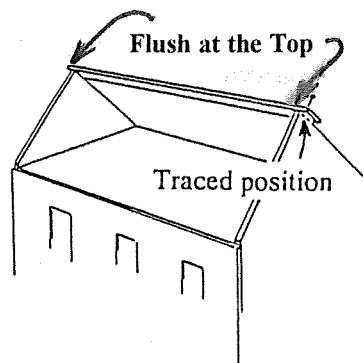

Illustration #10

5. Glue and nail the Front Roof in place flush at the top of the Rear Roof, and lined up with the traced lines (Illustration #11).

6. Glue and nail the Eaves (2" x 10 1/2") in place on the remaining exposed edge of the sides, flush at the outside edge of the Rear Roof (Illustration #12).

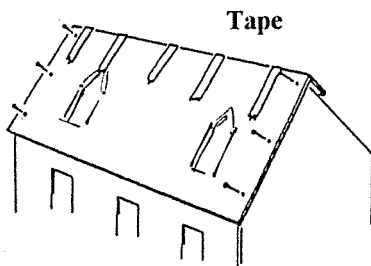

Illustration #11
Nail Through
Pre-punched Holes

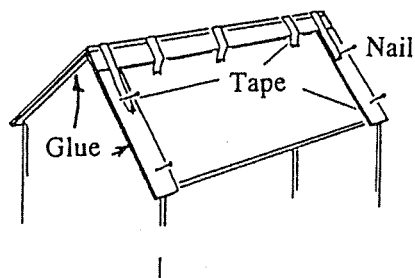
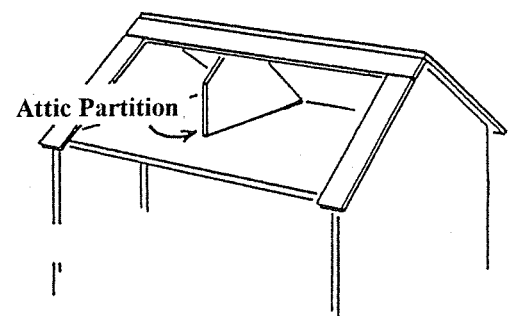

Illustration #12



Finish the Outside:

Debbie's Dollhouse is designed to accept many components, details, and Add-ons. Plan ahead when designing the exterior of your dollhouse so that the extras go on in the right order.

Our assembly pro follows this general order when finishing the outside of a dollhouse:

- Install 45° Dormers and Chimney
- Finish the walls: clapboard, or tudor, Stucco, brick, stone, etc.
- Paint the walls
- Pre-paint and install front and top steps centered beneath the door
- Glue on pre-painted trim, gingerbread, etc.
- Install pre-painted door and windows
- Shingle the roof

Interior Finishing:

Our pro finishes the interior of a few houses each year. Here's the order that he follows for tackling the interior finishing:

- Electrical wiring (he only uses **tape** style)
- Score and stain floors
- Dividers and Attic Partitions
- Wallpaper (use "YES" brand paste)
- Stairs
- Carpeting
- Molding and trim

Set up the Dividers without glue to test their position, then repeat the setup, gluing the Dividers in place.

- 1: Mid Floor 15⁷/₈ Divider flush to the stair opening
- 2: 2⁵/₈ Dividers to block off the stairs
- 3: 4¹/₂ Bathroom Divider with door cutout, note the overlap
- 4: 15⁷/₈ Divider
- 5: Base Floor Divider lined up
- 6: Attic Partitions lined up

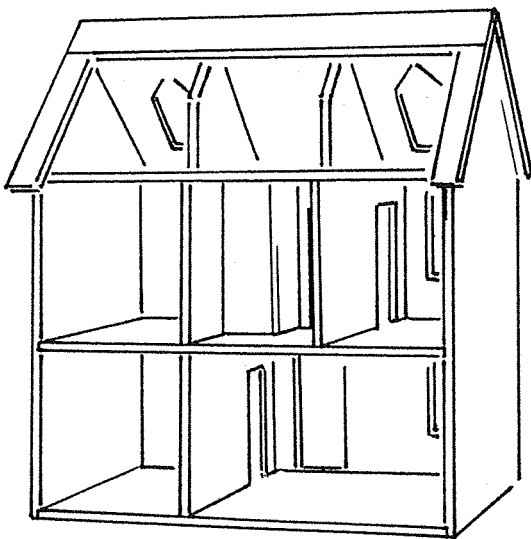

Front

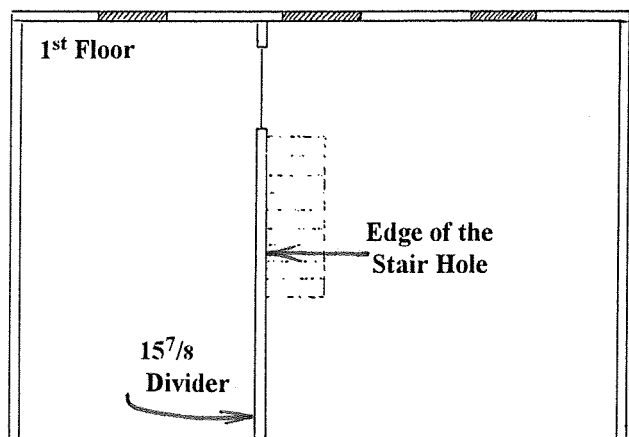
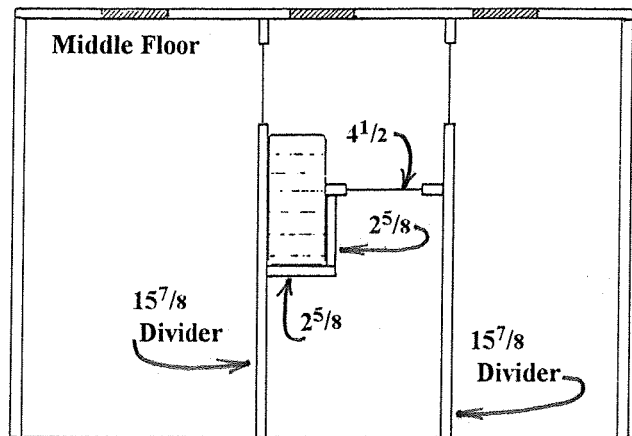

**Your Debbie's Dollhouse is done...
Enjoy the rest of your project!**